

SCALE

SEC. 11 T.2N. R.33E.WM SE 1/4 NE 1/4
UMATILLA COUNTY

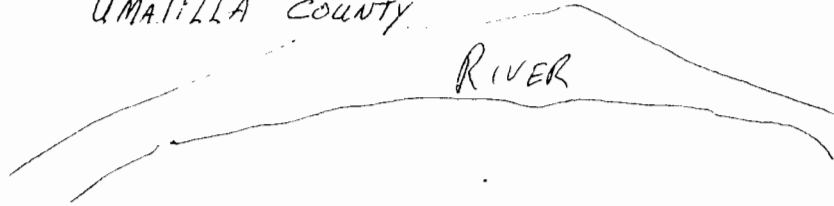

RECEIVED

MAY 11 1979

WATER RESOURCES DEPT.
SALEM, OREGON

Application No. 58642
Permit No. 44221

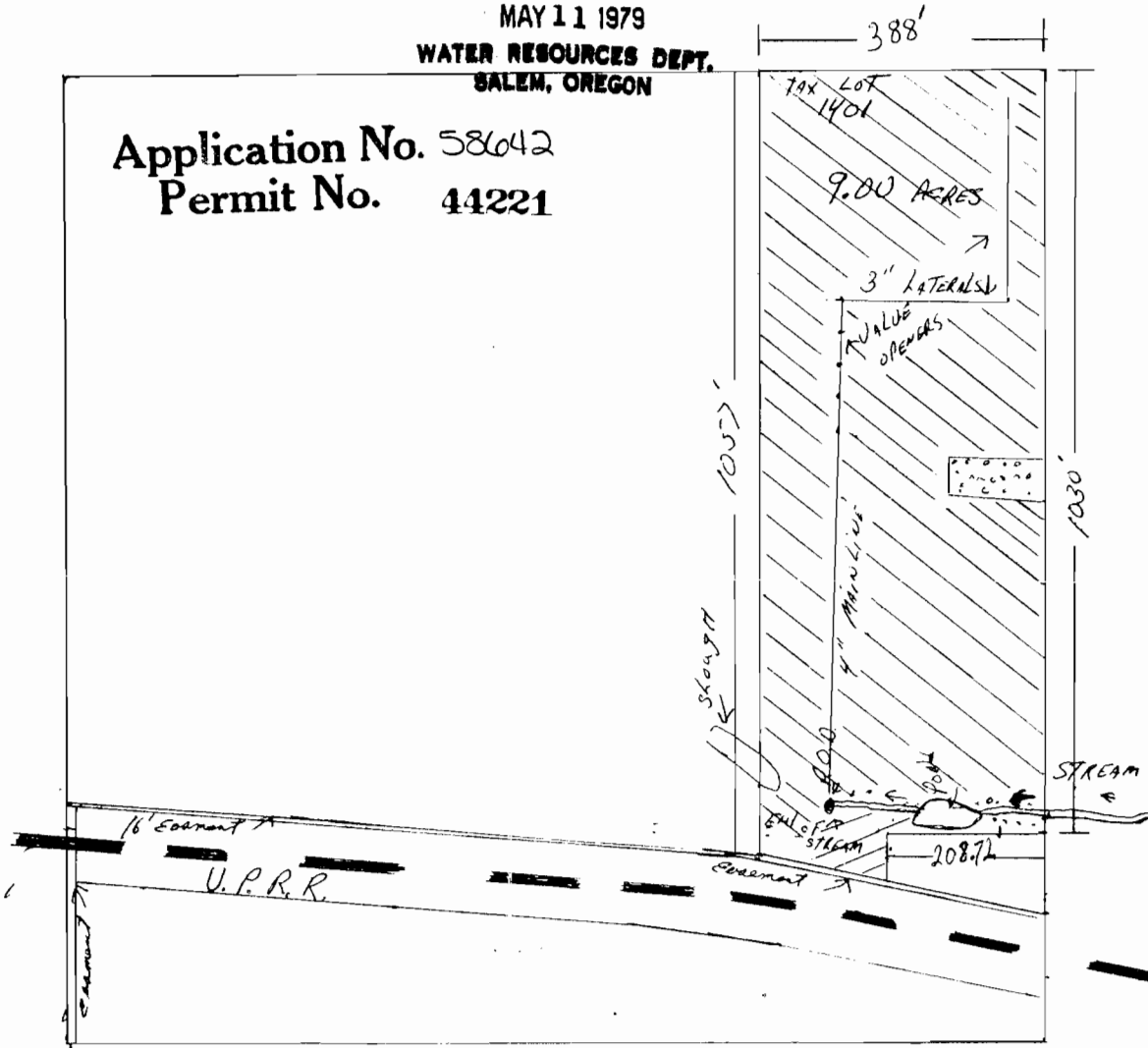

Div Pt. Loc. 450' N & 295' W.
from E 1/4 cor Sec. 11

E 1/4 cor.

