

Bertha Gamill
Application No. 44232 and 44233
Permit No. 7833 and 7834

Location Map
Gammill Reservoir
Bertha Gamill
Sec. 17 T. 38 S. R. 1 W. W. M.
Scale 1" = 400'

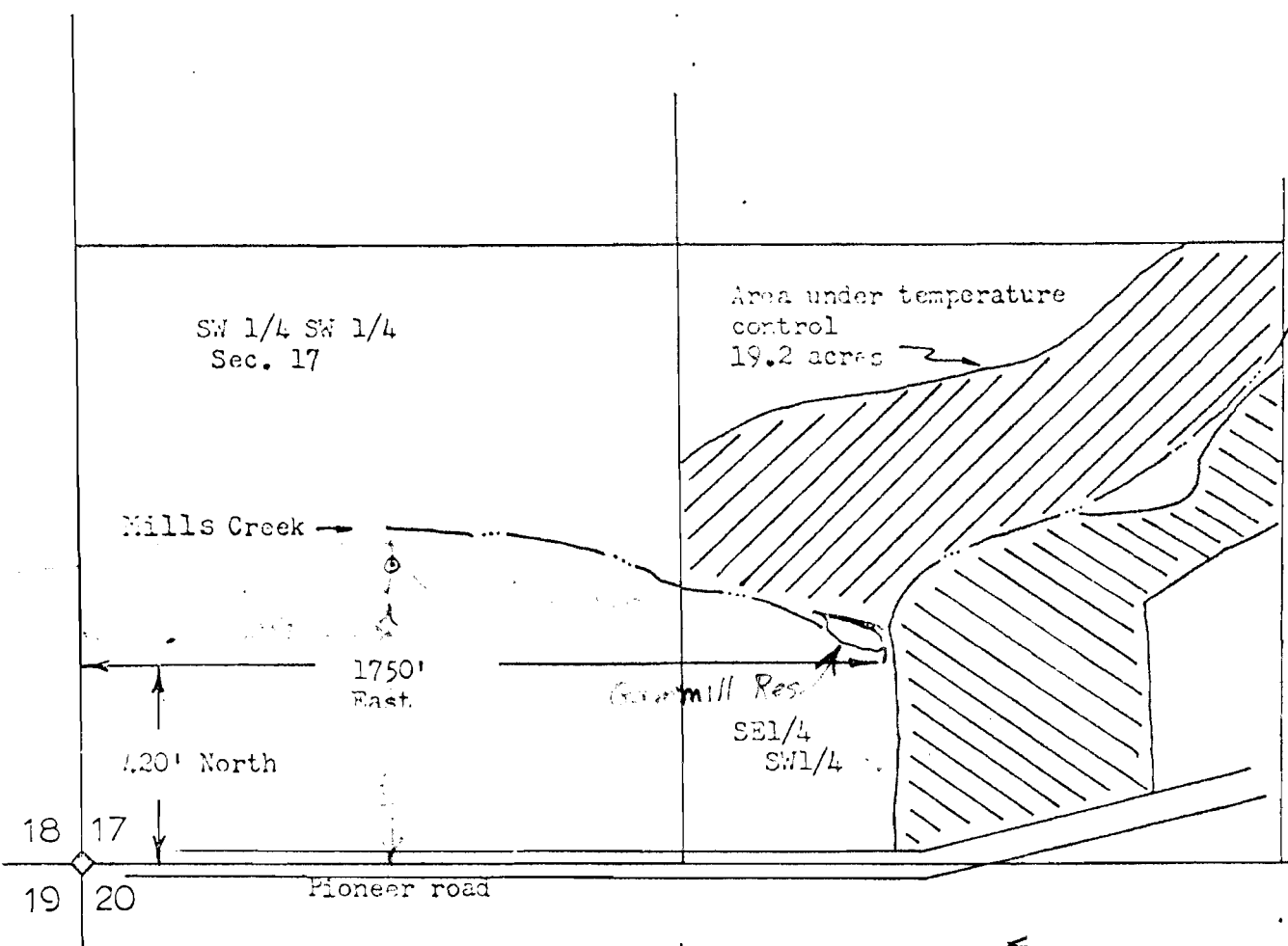

Application No. *R57070*
57071
Permit No. *R 7833*
44232



RECEIVED
JUN 14 1979
WATER RESOURCES DEPT.
SALEM, OREGON

Frederic Wilcox

R 57070 + 57071
R 45782 + 45783
R 55333 + 3346