

CrownZellerbach
Northwest Timber Operations

T-65 REV. 4/71
(POLICY #32)

- LOGGING CONTRACT CONSTRUCTION CONTRACT ROAD USE AGREEMENT
 TIMBER PURCHASE AGREEMENT EASEMENT - R/W AGREEMENT
 OTHER (SPECIFY) Water Right Permit

TWP 27 South RANGE 7 East SEC 23 FILE _____
DIVISION Jahr. Mazama SCALE 1"= 1000' BY E.N.W.
COUNTY Wasco STATE Oregon DATE December 1, 1976 APPROVED _____

PLAT 1 of 3

RECEIVED
FEB 7 1979
WATER RESOURCES DEPT.
SALEM, OREGON

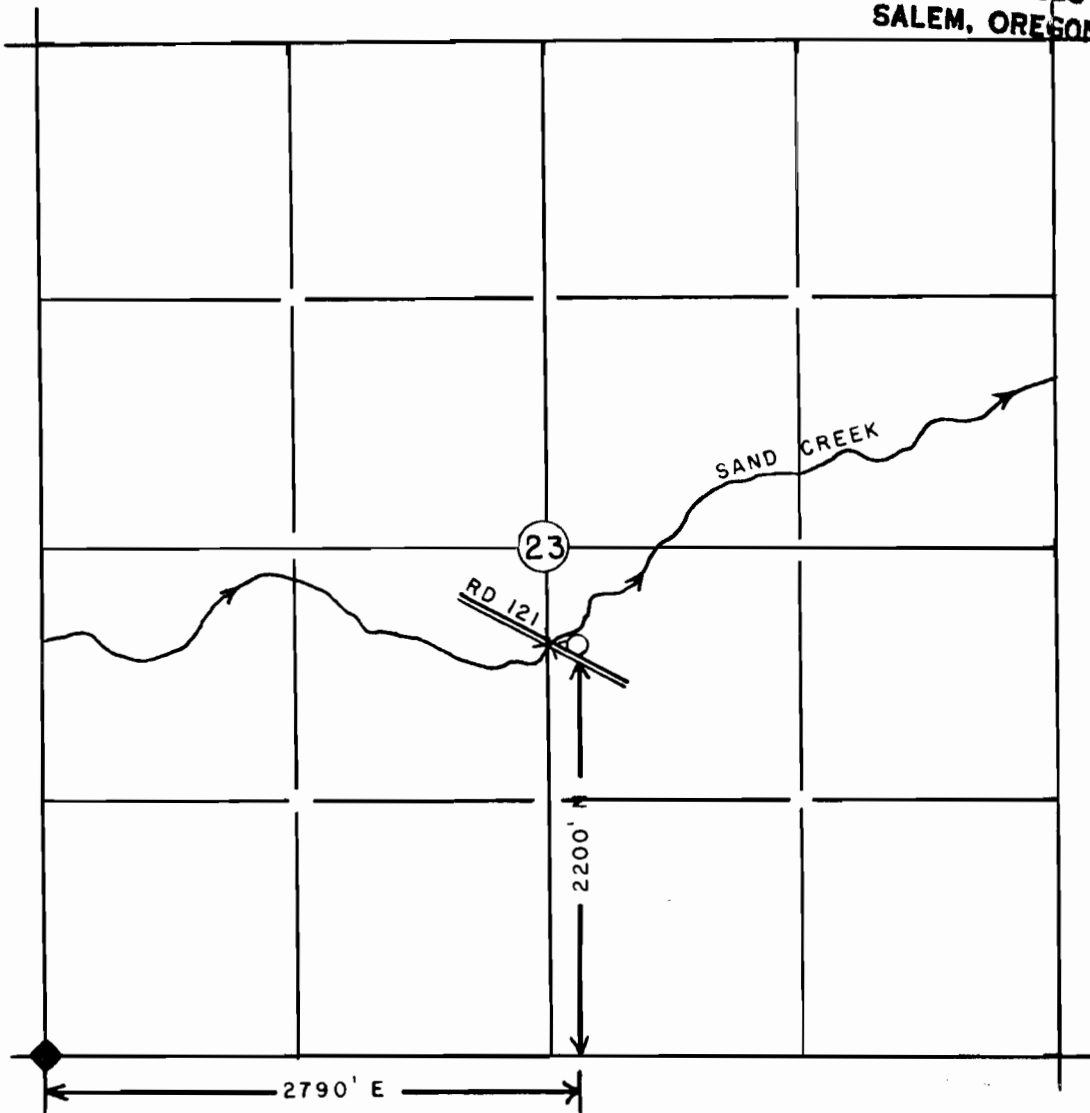

Section corner common to sections 22, 23, 26 and 27 marked by brass cap and 1 bearing trees.

Application No. 840871
Permit No. 44372

RECEIVED
FEB 7 1979
WATER RESOURCES DEPT
SALEM, OREGON

LEGEND

- ◆ ESTABLISHED CORNER EXISTING ROAD ESTABLISHED PROPERTY LINE
◇ APPROXIMATE CORNER PROPOSED ROAD

AREA

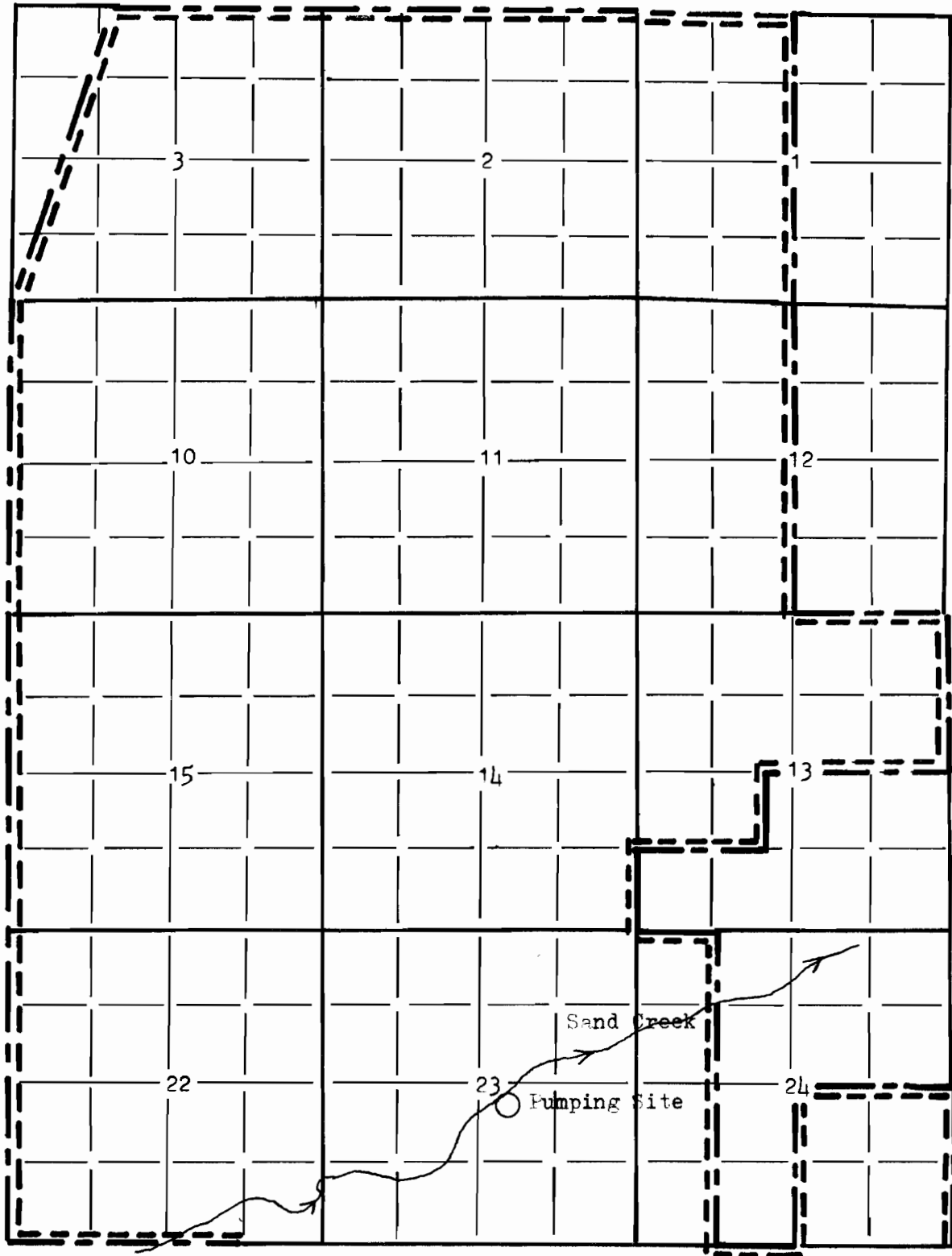

CROWN ZELLERBACH
 WATER RIGHT PERMIT

Plat 2 of 3

TWP. 31 SOUTH RANGE 7 EAST
 SCALE: 2" = 1 MILE

KLAMATH COUNTY, OREGON
 JUNE 7, 1979

----- GRAZING BOUNDARY
 _____ FIRE PROTECTION BOUNDARY

Application No 55059
 Permit No. 44372

E.N.M.

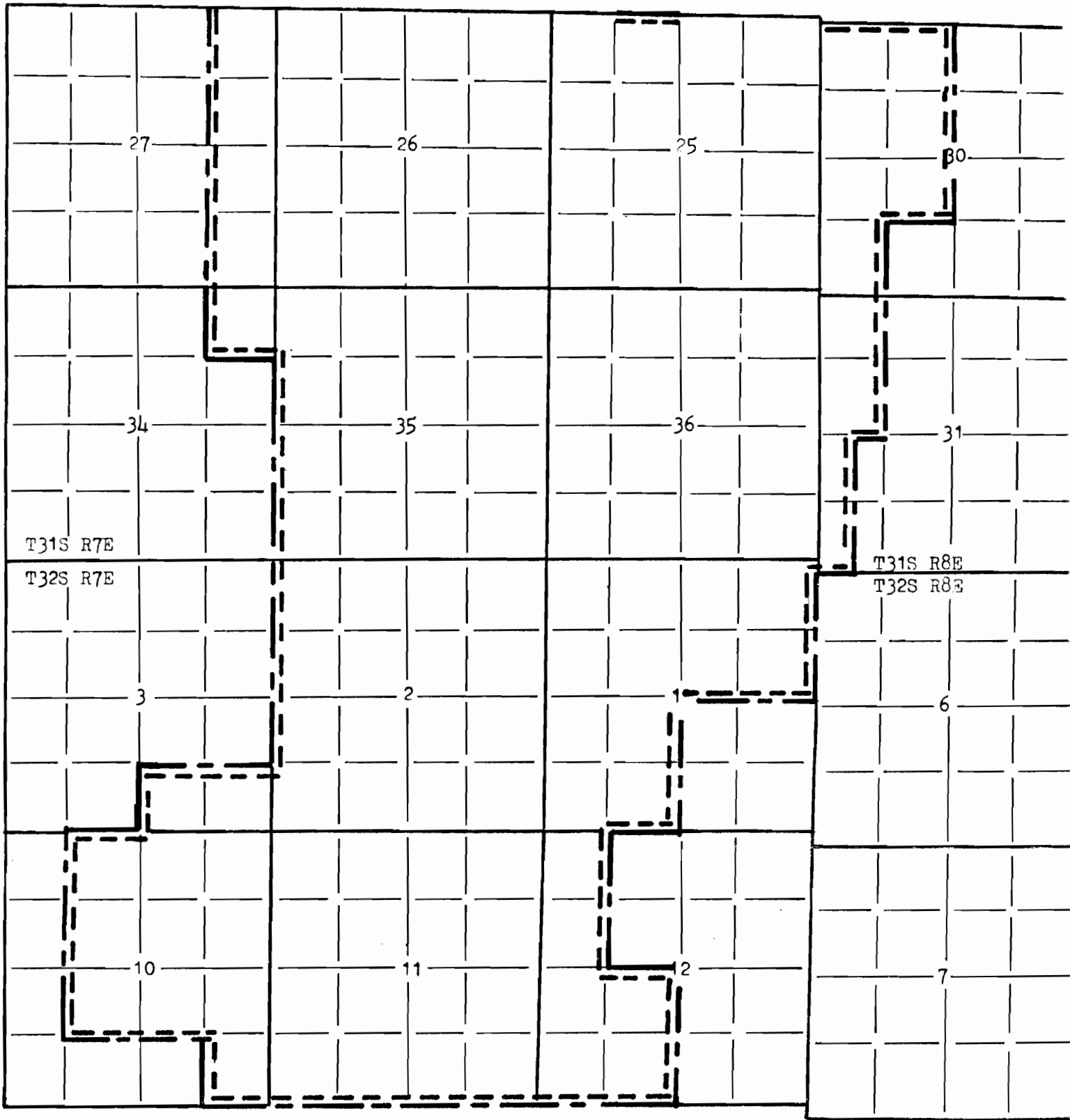

CROWN ZELLERBACH
WATER RIGHT PERMIT

Plat 3 of 3

TWP. 31, 32 SOUTH RANGE 7, 8 EAST

KLAMATH COUNTY, OREGON

SCALE: 2" = 1 MILE

JUNE 7, 1979

----- GRAZING BOUNDARY
 _____ FIRE PROTECTION BOUNDARY

Application No. 55059

Permit No. 44372