

Application No. 58930
 Permit No. 44430

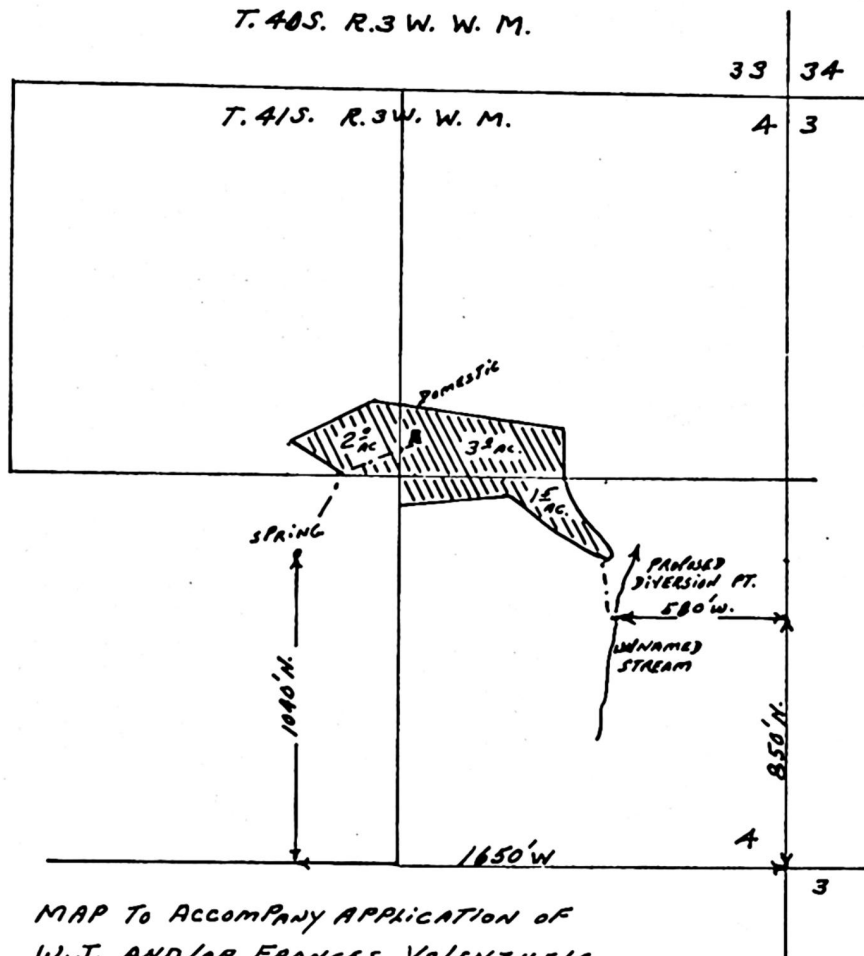

MAP TO ACCOMPANY APPLICATION OF
 W.J. AND/OR FRANCES VALENZUELA
 FOR DOMESTIC USE FROM A SPRING AND
 SUPPLEMENTAL IRRIGATION TO CERT. 16455
 AND CERT. 16456 FROM UNNAMED STREAM

SCALE 8" = 1 MILE

THIS MAP PREPARED BY:

John F. Curran
 FOR INFORMATION FURNISHED BY
 THE APPLICANT.

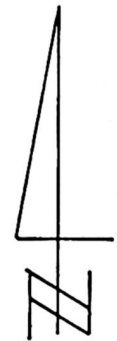

7-17-79

RECEIVED
 JUL 18 1979
 WATER RESOURCES DEPT
 SALEM, OREGON