

pp. 05

Township 38 S ,

Range 8. W ^{to town}

Lead line to town
Dance
Tank
Creek

OFFICE OF STATE ENGINEER
RECEIVED
MAR 22 1920
SALEM, OREGON

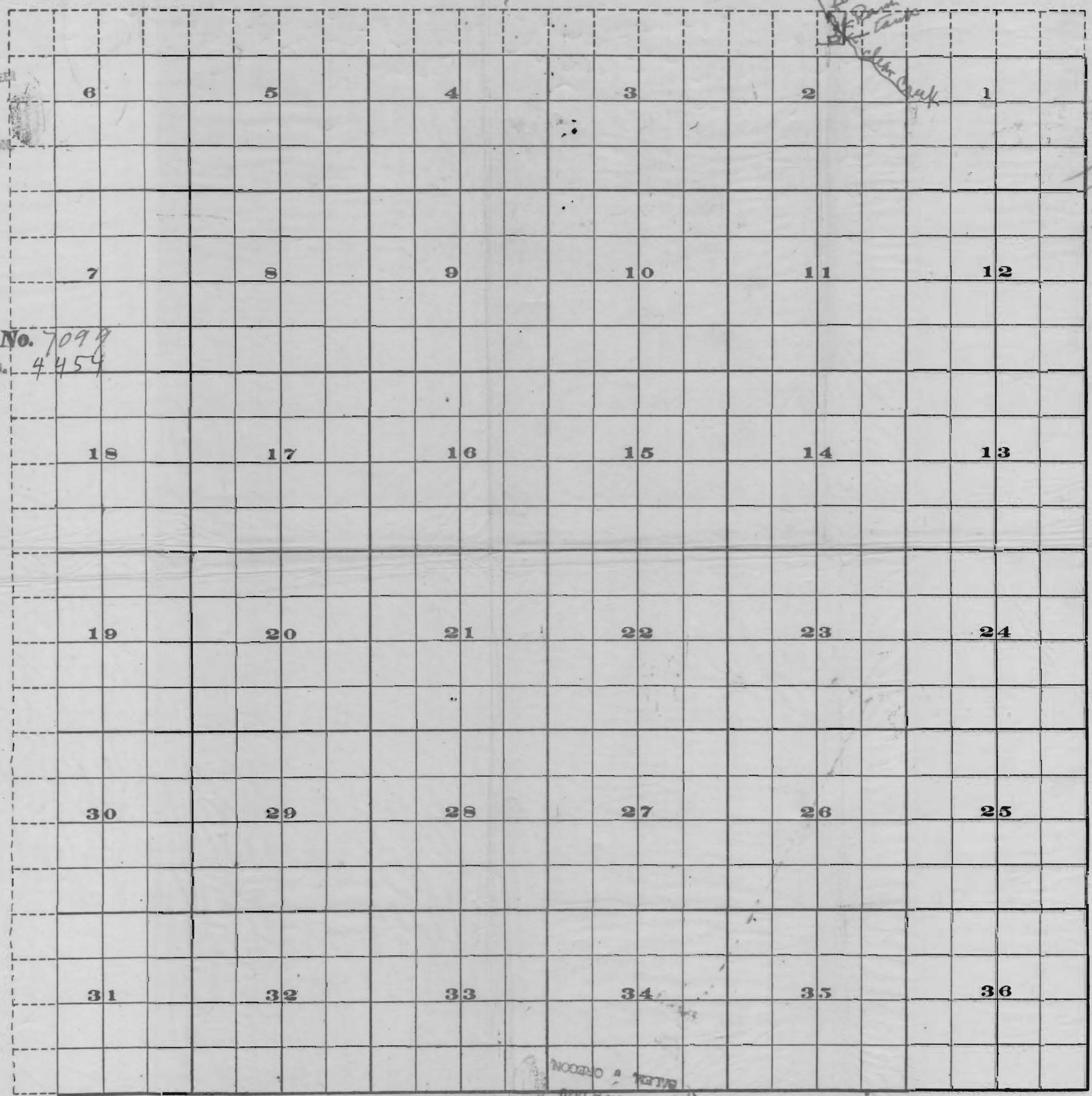

Application No. 7099
Permit No. 4454

pp. 05

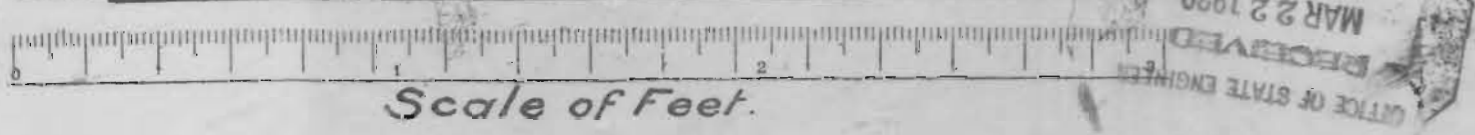

OFFICE OF STATE ENGINEER
RECEIVED
MAR 22 1920
SALEM, OREGON

FROM OFFICE OF THE STATE ENGINEER, SALEM, OREGON

pp. 05