

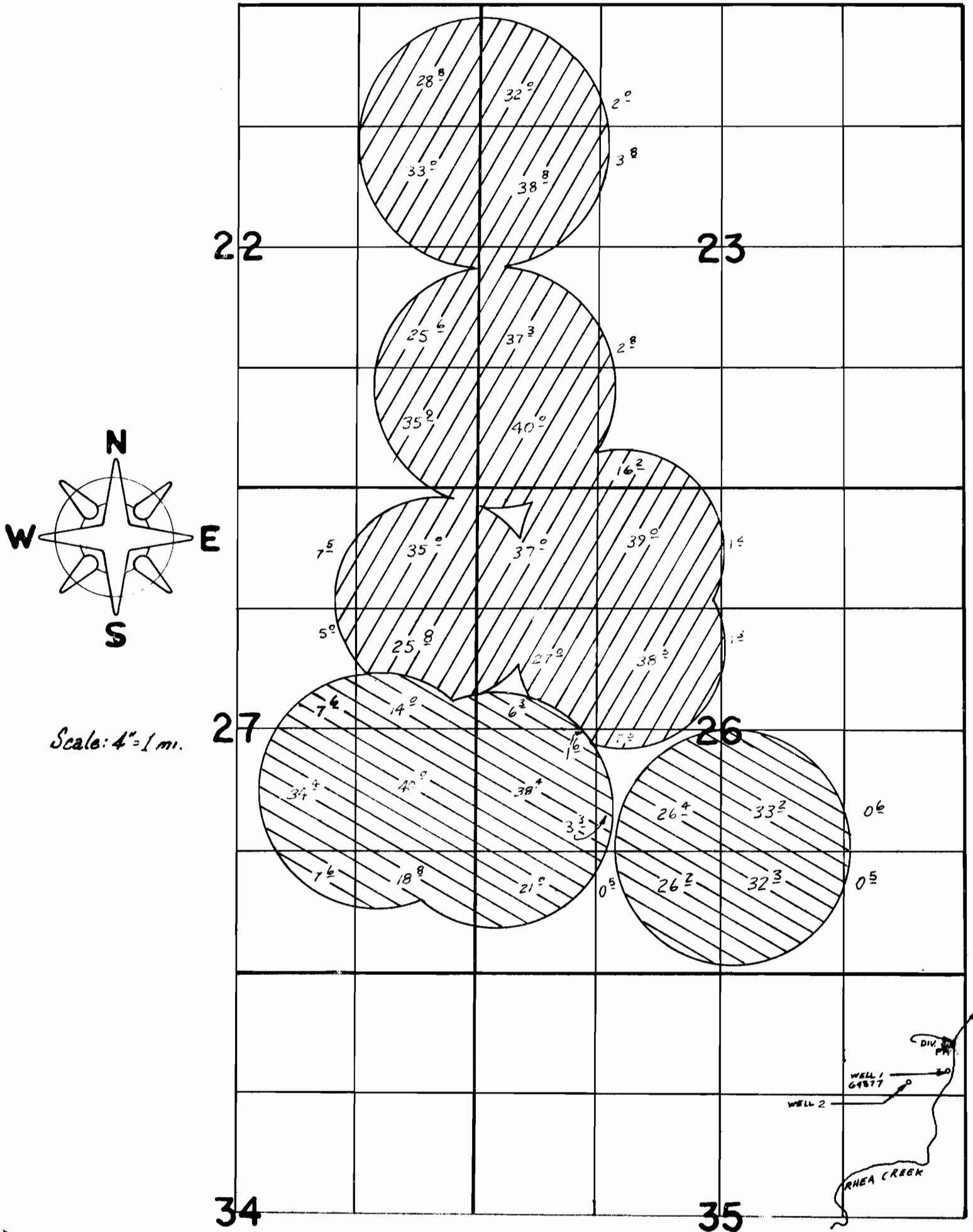

T. 1S., R. 24E., W.M.



WELL 1 LOCATED 1050' S. & 210' W. FROM NE COR SEC 35
 WELL 2 LOCATED 1180' S. & 620' W. FROM NE COR SEC 35
 DIV. PT. LOCATED 750' S. & 140' W. FROM NE COR SEC 35

-  Primary irrigation from Wells 1 & 2
Suppl from Rhea Cr.
-  Suppl from Well 2
Suppl from Rhea Cr.

Application No. 77-11-
 Permit No. 44568

THIS MAP PREPARED BY:
 FROM INFORMATION FURNISHED BY
 THE APPLICANT