

T. 39 S. R. 6 W., W.M.

SEC. 30

NW 1/4 SW 1/4

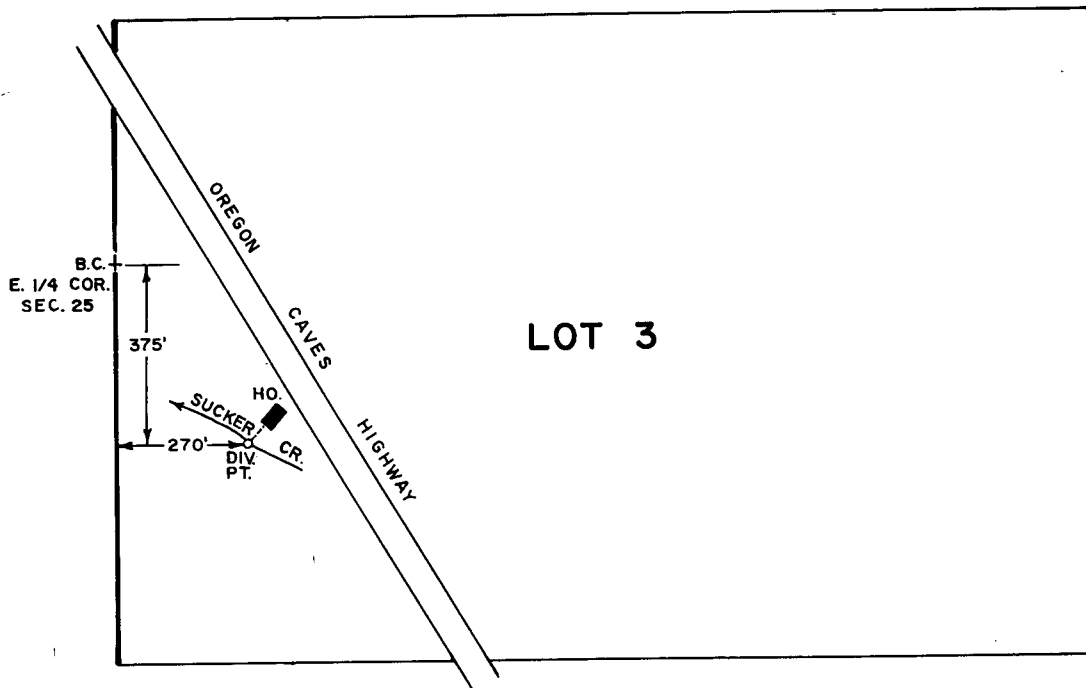

RECEIVED

APR 15 1987

2ND DIST. 14
GRANTS PAGE, ~~ONE~~

FINAL PROOF SURVEY
UNDER

Application No. 58817 Permit No. 44626
IN NAME OF

VIRGIL FRANKLIN & JOANNE SUE LEMLEY

Surveyed AUG. 25, 1982, by B. SUZIE JAMES

Scale: 1" = 400'

PTS-1982-14A twb