

T. 36 S. R. 6 W., W. M.

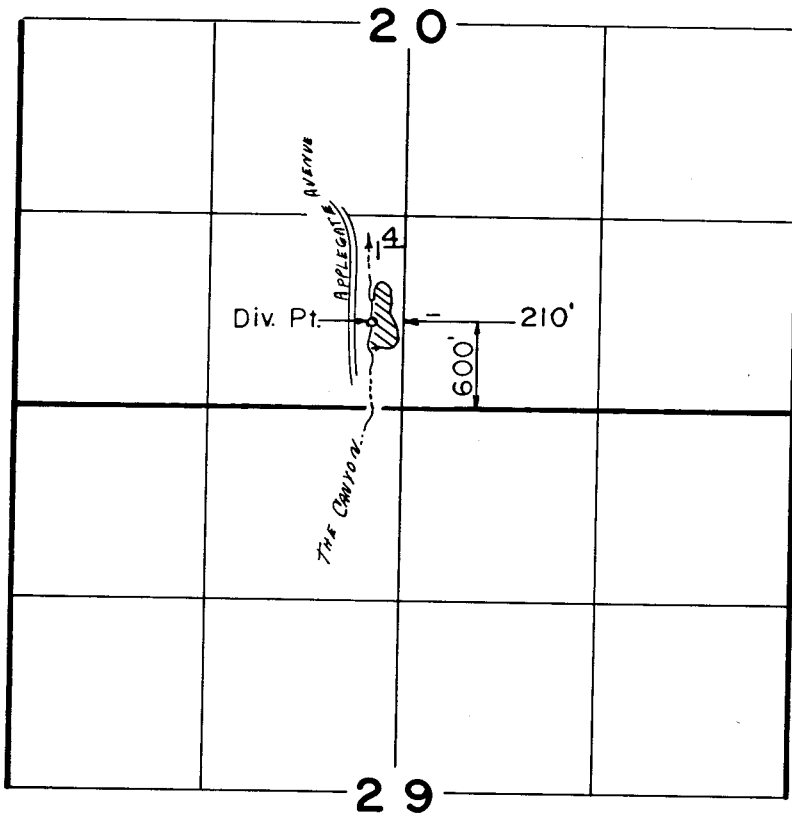

Scale: 1" = 1320'

RECEIVED

MAR 28 1991

WM. DIST. 14
GRANTS PASS, ORE.

FINAL PROOF SURVEY
UNDER

Application No. 59303 Permit No. 44756
IN NAME OF

RONALD & ANN PADGETT

Surveyed AUG. 30. 1988., by B. S. JAMES.

B50-5-16

L.M.J.