

RECEIVED

MAR 11 1985

WATER RESOURCES DEPT  
SALEM, OREGON

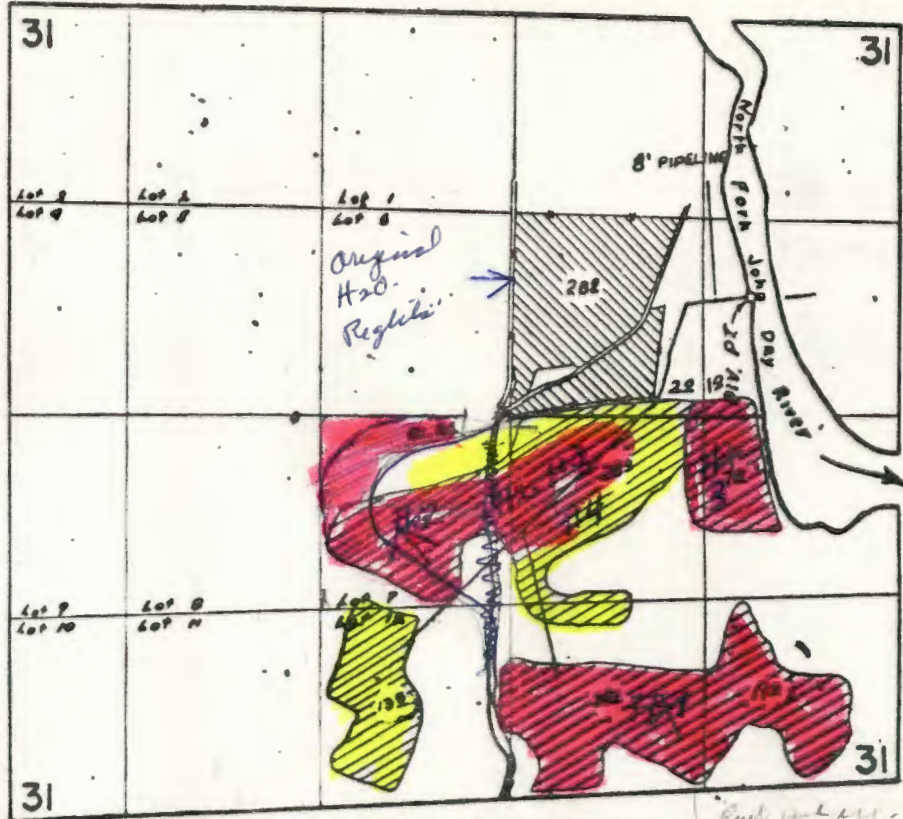

DIV. PT. LOC. 830' N & 1640' E FROM CENTER SEC. 31

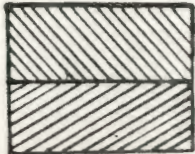

- Certificate # 38814
- Acreage this application

SCALE 4" = 1 MILE

**FINAL PROOF SURVEY**  
UNDER

X Dan E. Maynard

Application No. ~~44902~~ Permit No. ~~44902~~  
IN NAME OF

~~STANLEY J. JOHNSON~~

~~STANLEY J. JOHNSON~~ PREPARED BY:

McKiddle

FROM INFORMATION FURNISHED BY

*The road shown on this map is the old wall creek road. We have made app. surveys, new line given all property by Patent.*

- #1 cultivated lines of timber here.
- #2 are as cleared & used during 1984
- #3 - shown by fence to be cleared.
- #4 yellow area - may not be irrigated. See steep slope adjacent to irrigate.
- #1 - gate - to help
- #2 - Irrigate & pack
- #3 - Proposed pasture
- #4 - ?

RECEIVED

FEB 19 1980

WATER RESOURCES DEPT  
SALEM, OREGON

Application No. 59800  
Permit No.

44902