

26	35
27	34

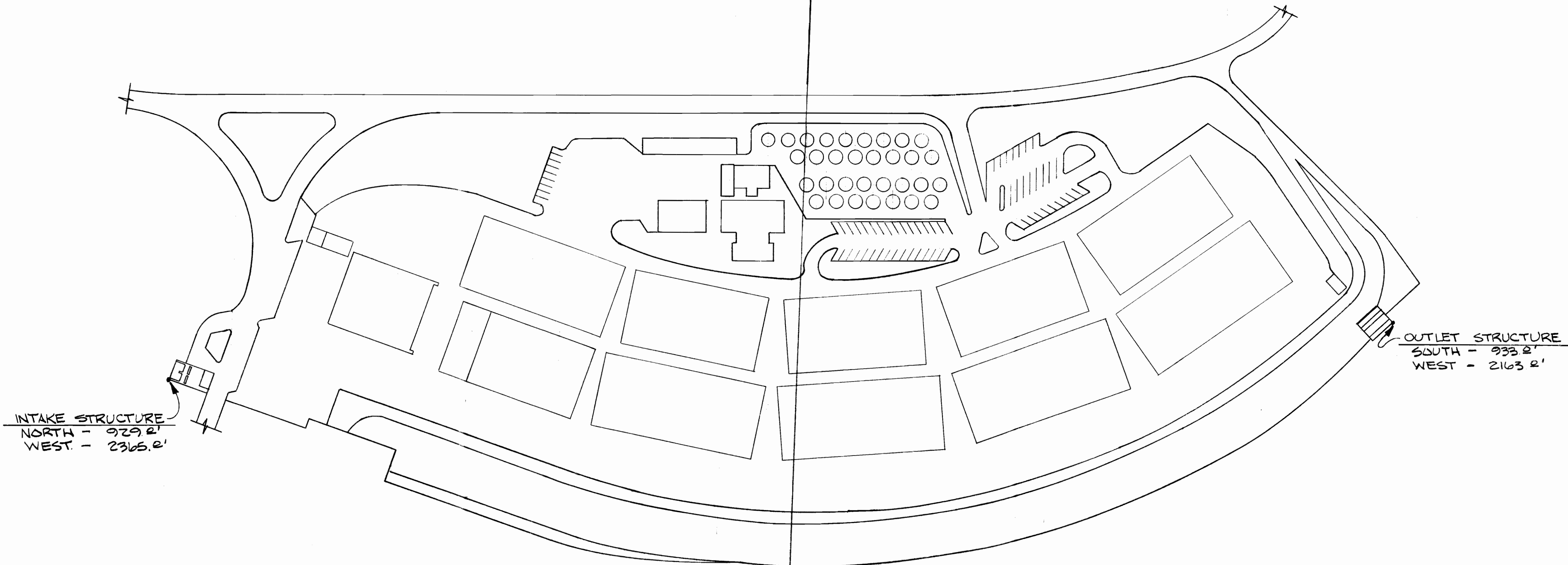

INTAKE STRUCTURE  
 NORTH - 929.2'  
 WEST - 2365.2'

OUTLET STRUCTURE  
 SOUTH - 933.2'  
 WEST - 2163.2'

Application No. 48639  
 Permit No. 44910

PLAN

SCALE 100' = 1"

REVISIONS		DEPARTMENT OF FISH & WILDLIFE STATE OF OREGON	
		COLE RIVERS HATCHERY	
		WATER RIGHTS APPL. TS. - 335, R-1E SEC. 26 & 27 & 34 & 35	
CHIEF ENGINEER		APP'VD	DIRECTOR
DATE	DESIGN BY G. KERNAN		
	DRAWN BY E. WHITED	FILE NO.	SHT. 1 OF 1
CHECKED BY			

