

RECEIVED
JUN 19 1980
WATER RESOURCES DEPT
SALEM, OREGON

T.15 S. R.31 E. W.M.

RECEIVED
JUL 21 1986
WATER RESOURCES DEPT
SALEM, OREGON
JUL 1 1980
WATER RESOURCES DEPT
SALEM, OREGON

APPLICATION MAP FOR
DENNIS CAWRSE

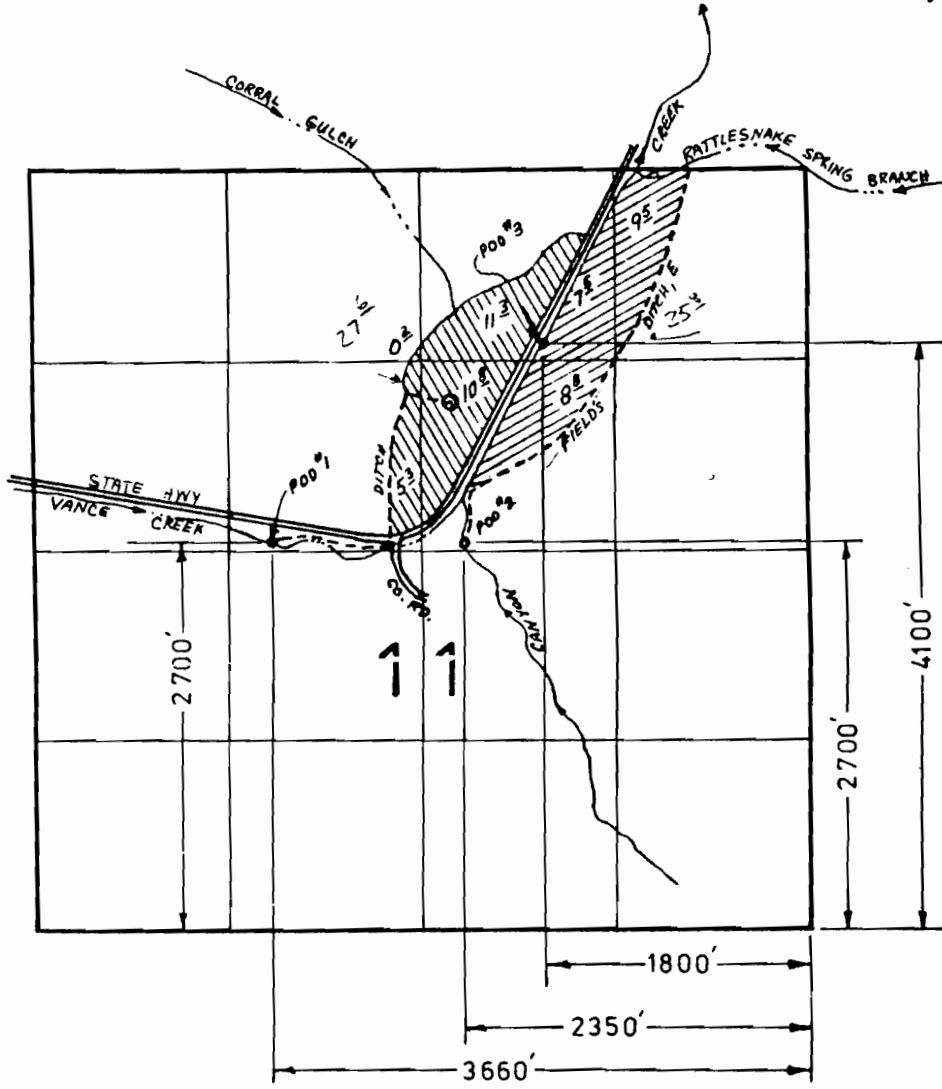

SCALE 4"=1mi

APPROVED *Dennis Cawrse*

MAP BASED ON U.S.G.S. QUAD MAP "CANYON MTN., OREG."

MAP PREPARED BY:
R.W. CETTEL JR.
ALL INFORMATION FURNISHED BY

Application No. 60374
Permit No. 15100