

Application No. 59396
Permit No. 45223

RECEIVED
APR 22 1980
WATER RESOURCES DEPT.
SALEM, OREGON

RECEIVED

JUL 24 1978

WATER RESOURCES DEPT.
SALEM, OREGON

T. 30 S., R. 3 E., W. M.
SEC. 34

APPLICATION MAP

NAME	APPLICATION NO.	PERMIT NO.	LOT
CECIL KEENAN			7
CATHERINE D. HOOD	56409		12
WILLIAM D. THORNDIKE	56410		13
JOHN H. & LOIS W. ENDERS	56411		6
KATHERINE SUE LEAVITT	56442		8
CLARENCE W. HARWOOD & JOHN H. NEILSON	56481		17
F.W. EBERLEIN	56493		4
ALICE L. LEDUC	56614		23
WARREN & BETTY CARKIN			2
PHILIP A. & ROSEMARY E. JANZ			3

 WATER USERS

SURVEYED JULY 11 & 12, 1978 BY B. SUND

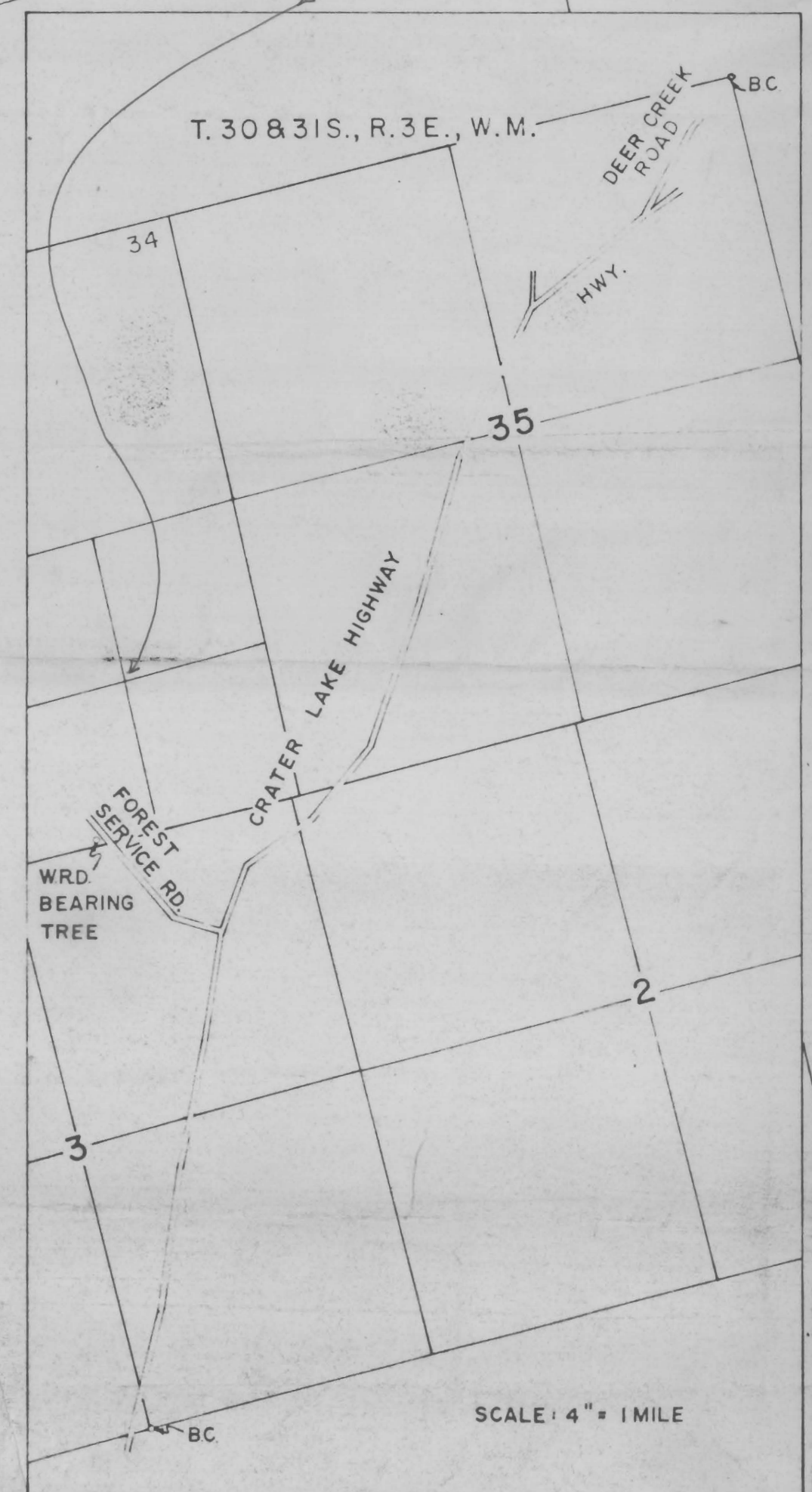

SCALE: 4" = 1 MILE

SCALE: 1" = 100'

ROGUE RIVER SUMMER HOME ASSOCIATION

BLOCK "A"

WRD BEARING TREE

DHM.
PTS. 1978-14-B

Keep this map with File #59396