

T5N, R43E.W.M.

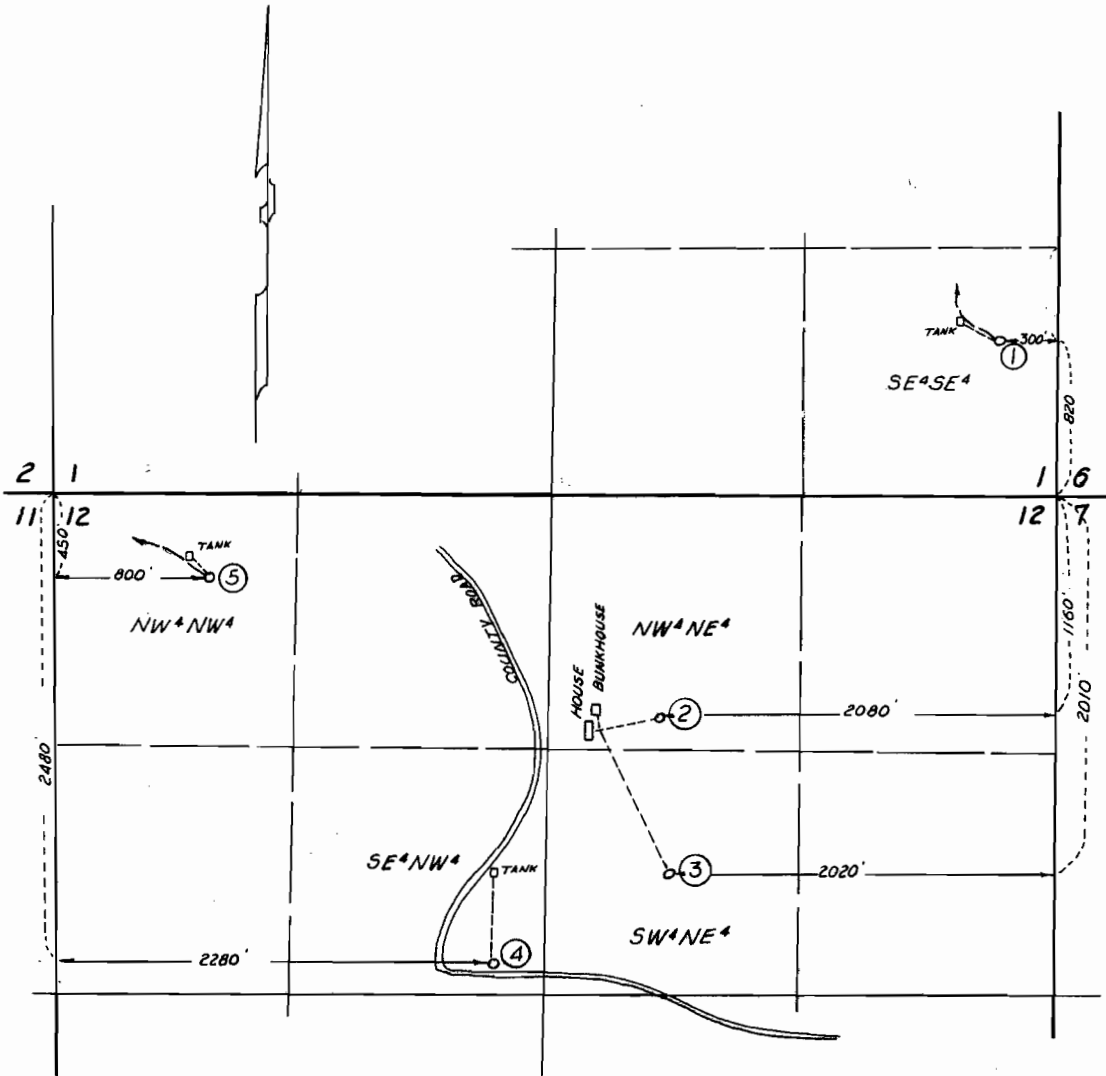

SCALE: 1" = 660'

Spring No.	Section	Location	Stock	Est. flow
1	SE ⁴ SE ⁴ , Sec. 1	North 820 ft, West 300 ft. from SE cor. Sec. 1	Stock	10 gpm
2	NW ⁴ NE ⁴ , Sec. 12	South 1160 ft, West 2080 ft. from NE cor. Sec. 12	Domestic	7 "
3	SW ⁴ NE ⁴ , " "	South 2010 ft, West 2020 ft. " " " "	"	8 "
4	SE ⁴ NW ⁴ , " "	South 2480 ft, East 2280 ft. " NW " "	Stock	5 "
5	NW ⁴ NW ⁴ , " "	South 450 ft, East 800 ft. " " " "	"	10 "

RECEIVED

DEC 26 1980

WATER RESOURCES DEPT
SALEM, OREGON

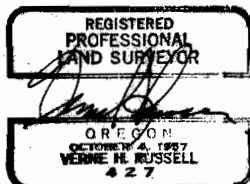

VERNE H. RUSSELL
LAND SURVEYING
ENTERPRISE OREGON

PREPARED FOR: ROBERT HAWKINS
BY: VERNE H. RUSSELL PLS 427
DATE: 2/5/80

Application No. 59917
Permit No. 45650