

RECEIVED

MAY 27 1981

WATER RESOURCES DEPT  
SALEM, OREGON

T29S R14W  
Sec 8  
NW 1/4 NW 1/4

RECEIVED

JUL 28 1980

WATER RESOURCES DEPT  
SALEM, OREGON

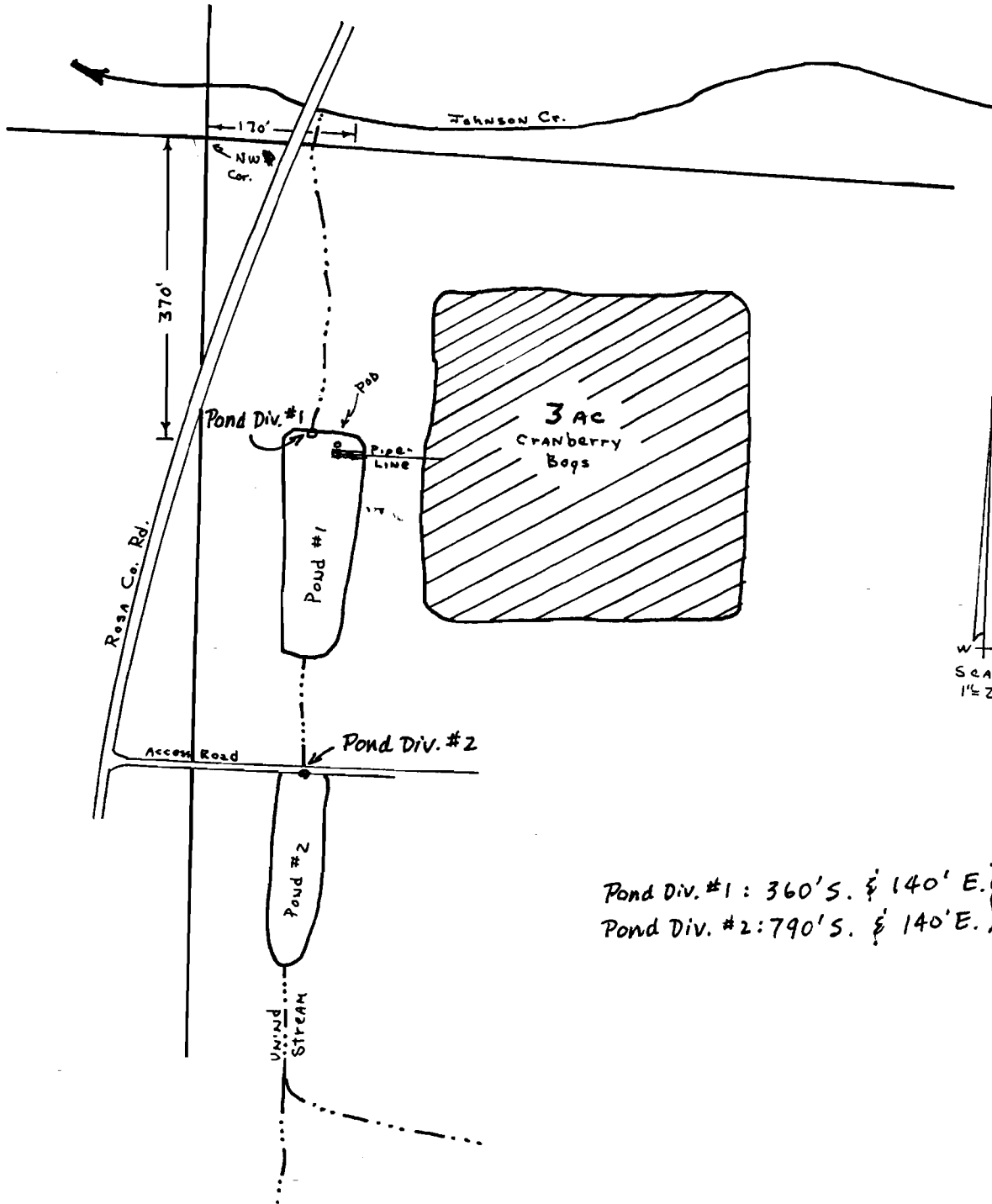

W + E  
Scale  
1" = 200'

Pond Div. #1 : 360' S. & 140' E. } from  
Pond Div. #2 : 790' S. & 140' E. } NW Cor. Sec. 8

Application No. R-60384 & 60385

Permit No.

R 8271

45773