

T. 33 S., & T. 34 S., R. 5 W., W.M.

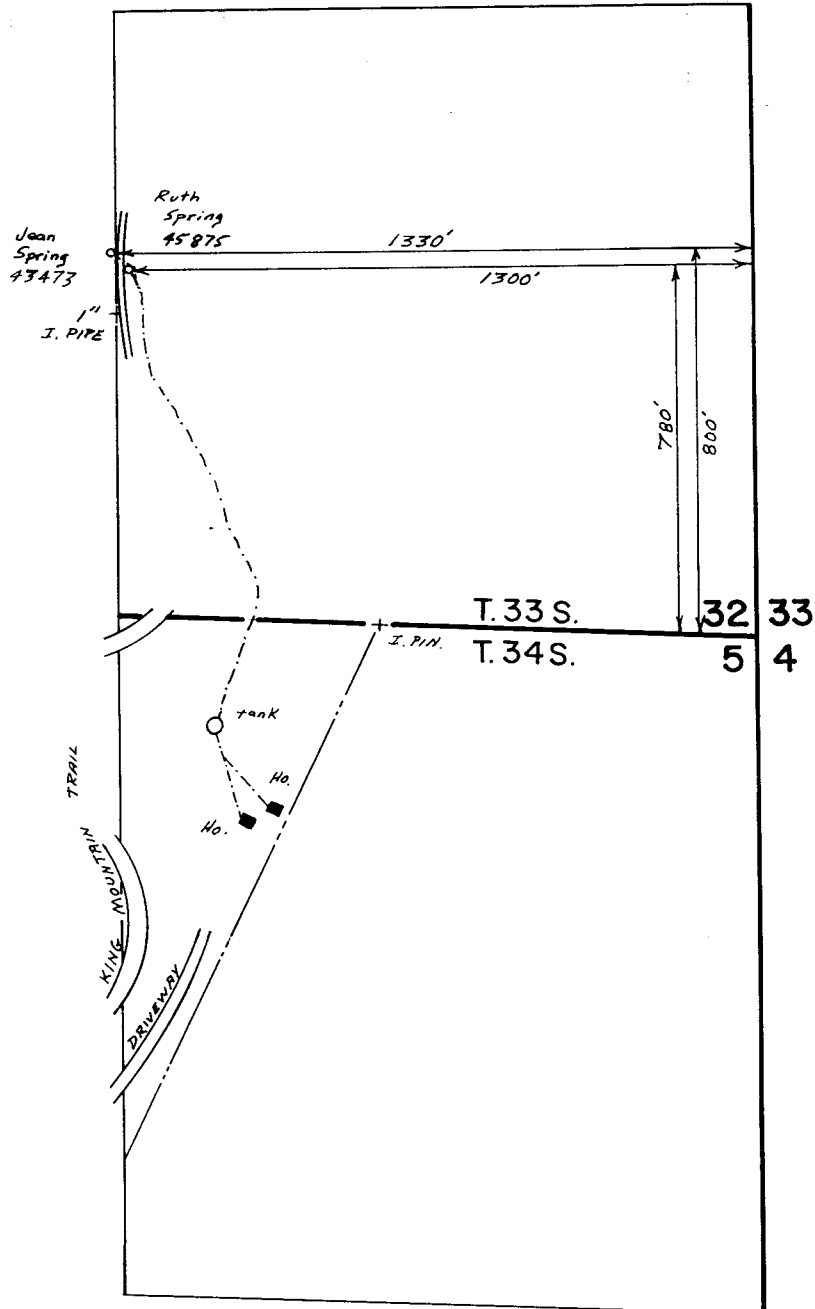

Scale 1" = 400'

JUL 14 1988

WM. DIST. 14
GRANTS PASS, ORE.

FINAL PROOF SURVEY
UNDER

57765 43473
Application No. 61634 Permit No. 45875
IN NAME OF

JEAN & RUTH MOUNTAINGROVE

Surveyed Aug. 28, 1986, by B.S. JAMES