

T. 36 S., R. 5 W., W.M.

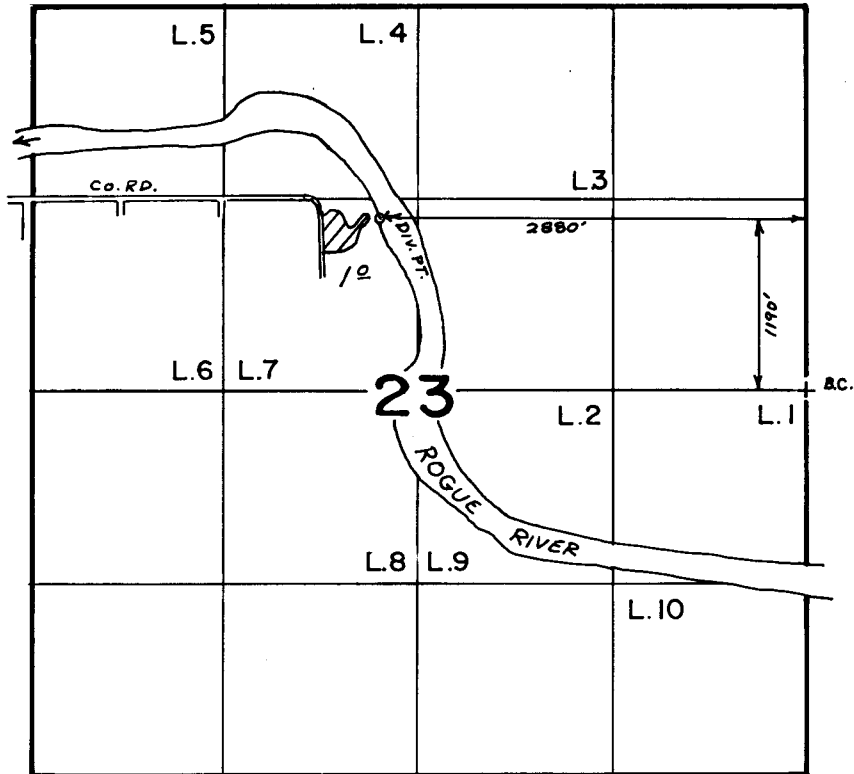

Scale 4" = 1 mile

FINAL PROOF SURVEY
UNDER

Application No. 61.751... Permit No. 45928....
IN NAME OF

JOSEPHINE CO. PARKS DEPT.

Surveyed Oct. 30, 1981, by Bruce R. Sund

RECEIVED

APR 1 1987

W.M. DIST. 14
GRANTS PASS, OREG.

B50-5-5

BSJ