

45936
37-5-36

T. 37 S., R. 5 W., W. M.

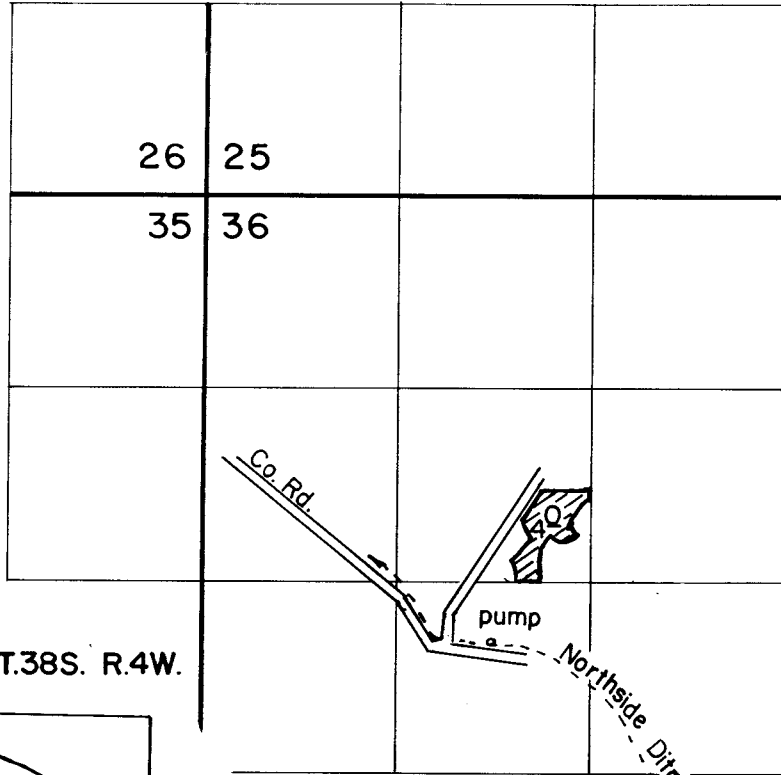

76.504

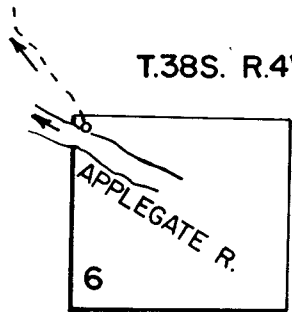

T.38S. R.4W.

NORTHSIDE
DITCH

Div. Pt.: 4000' S. & 80' E. from
N.W. cor. Sec. 6

Scale: 1" = 1320'

FINAL PROOF SURVEY
UNDER

Application No. 61895... Permit No. 45936...
IN NAME OF

DONALD M. FERRELL

Surveyed NOV. 14, 1989, by B. S. JAMES