

RECEIVED

JUL 16 1981

WATER RESOURCES DEPT  
SALEM, OREGON

Scale 1" = 1320'

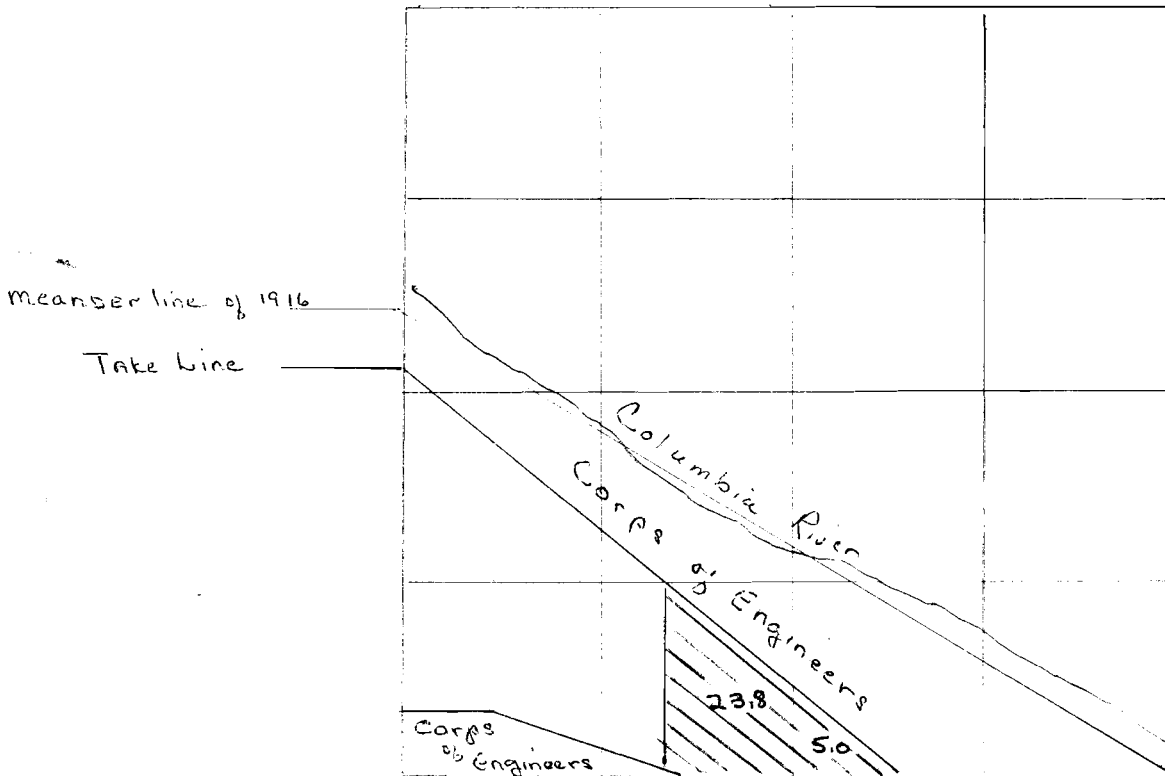

$\frac{T}{5N}$	$\frac{R}{26}$	$\frac{Sec.}{15}$	$\frac{40}{SESW}$	23.8
			SWSE	5.0

Total 28.8

Application No. 61797

Permit No. 45999

RECEIVED

JUN 29 1981

WATER RESOURCES DEPT  
SALEM, OREGON

SHEET 2 of 9

**RECEIVED**

JUL 16 1981

WATER RESOURCES DEPT  
SALEM, OREGON

Scale 1" = 1320'

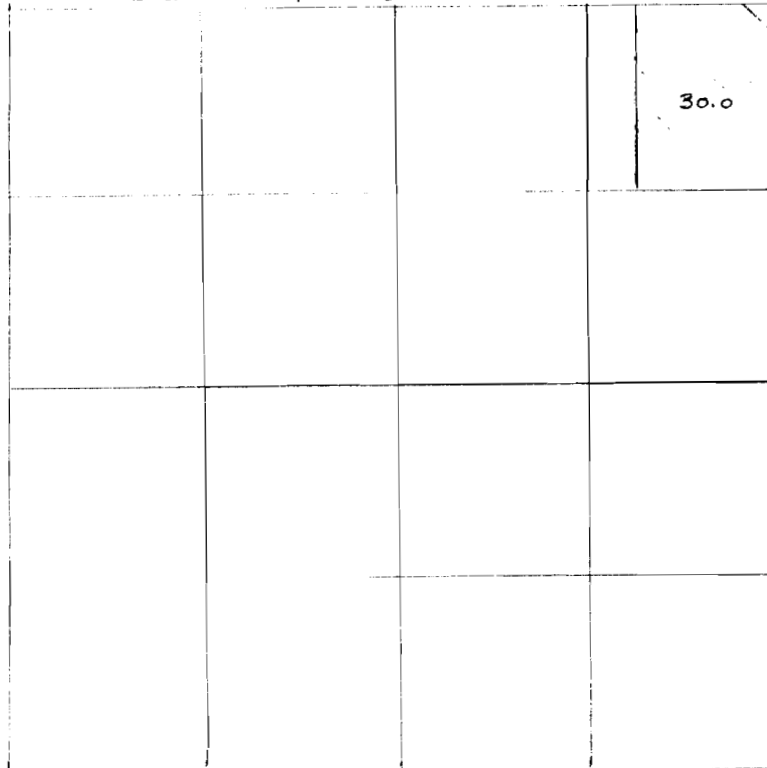

T 5 N Range 26 E.W.M. Section 27

NENE  
30.0

total: 30.0

Application No. 61797

Permit No. 45999

**RECEIVED**

JUN 29 1981

WATER RESOURCES DEPT  
SALEM, OREGON

SHEET 8 of 9

RECEIVED

FEB 09 1999

WATER RESOURCES DEPT.  
SALEM, OREGON

T-8181

WEST EXTENSION IRRIGATION DISTRICT  
POINT OF DIVERSION  
COLUMBIA RIVER PUMP STATION  
PERMIT NUMBER 45999

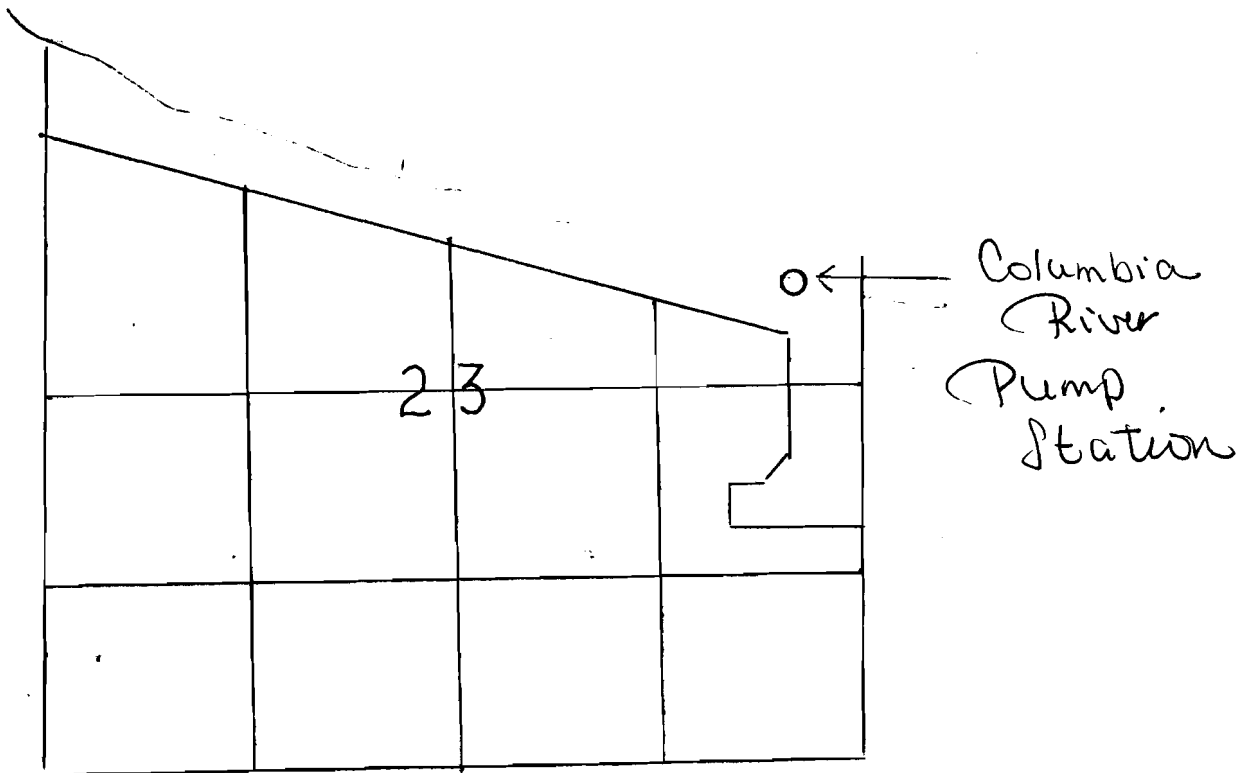

T 5N R 26 E WM Sec. 23 SENE Scale 1" = 1320'

Point of Diversion 800 ft. North and 200 ft. West from the E $\frac{1}{4}$  corner  
Section 23

Map 1 of 6

T-8181 RECEIVED

T. 4N., R. 26E., W.M.

MORROW COUNTY

SCALE 1" = 1320'

FEB 09 1999

WATER RESOURCES DEPT  
SALEM, OREGON

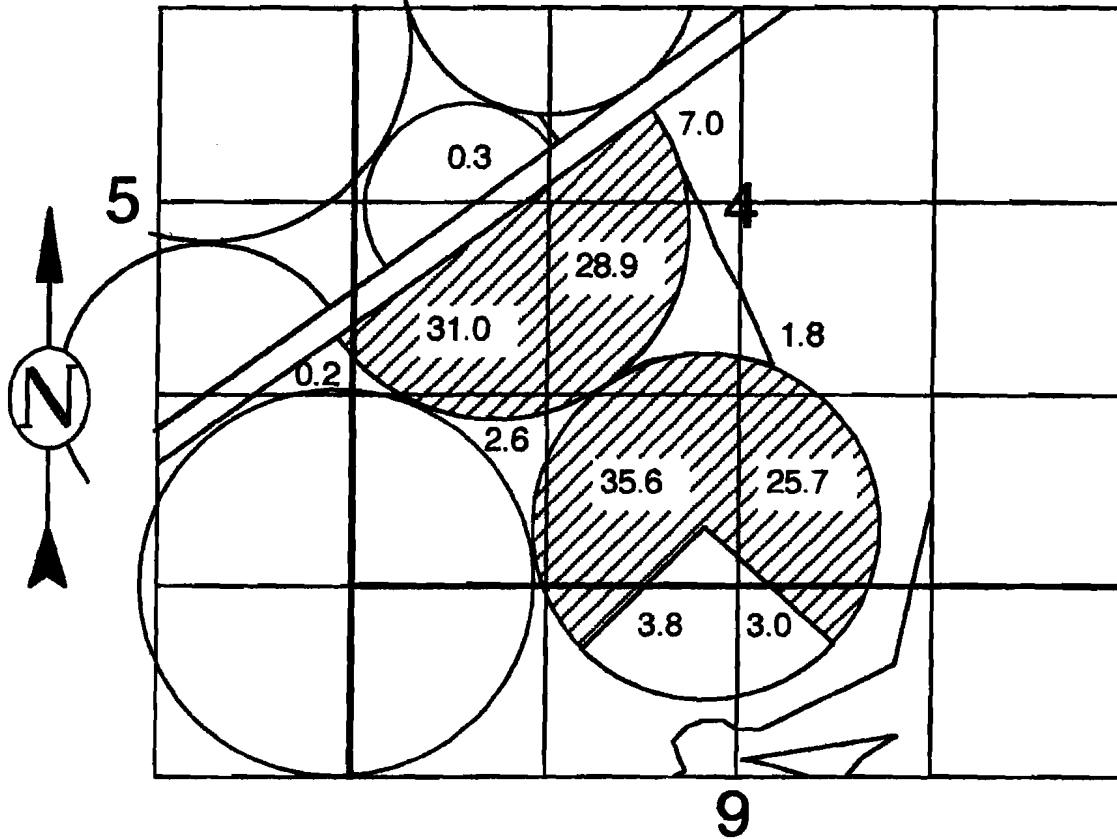

WATER RIGHTS TRANSFER MAP

 Water Rights Transferred To This Location

IN NAME OF

**West Extension Irrigation District**

T4N	R26E	Section	1/4 1/4	W/R acres transferred	Total W/R acres after transfer
			SW NW	0.3	0.3
			SE NW	7.0	7.0
			NE SW	28.9	28.9
			NW SW	31.0	31.0
			SW SW	2.6	2.6
			SE SW	35.6	35.6
			NW SE	1.8	1.8
			SW SE	25.7	25.7
			NE SE	0.2	0.2
			NW NE	3.0	3.0
			NE NW	3.8	3.8
				139.9	139.9

ENGINEERING - SURVEYING - WATER RIGHTS

**R V McKINNIS ENGINEERING**

Rt 1 Box 1122 Hermiston, Oregon 97838

541-567-2017

map 6 of 6

**RECEIVED**  
 AUG 07 2001  
 WATER RESOURCES DEPT  
 SALEM, OREGON

**WEST EXTENSION IRRIGATION DISTRICT  
 WATER RIGHT TRANSFER MAP  
 AMENDMENT TO PERMIT NO. 45999  
 2001**

Scale 1" = 1320'

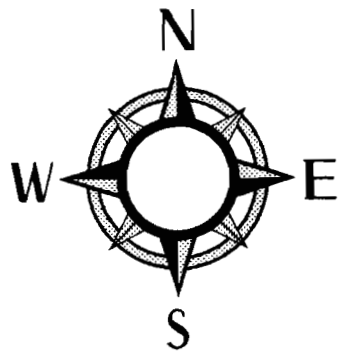

**Legend**

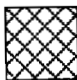
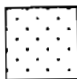
-  Existing Permit
-  Transferred off
-  Proposed

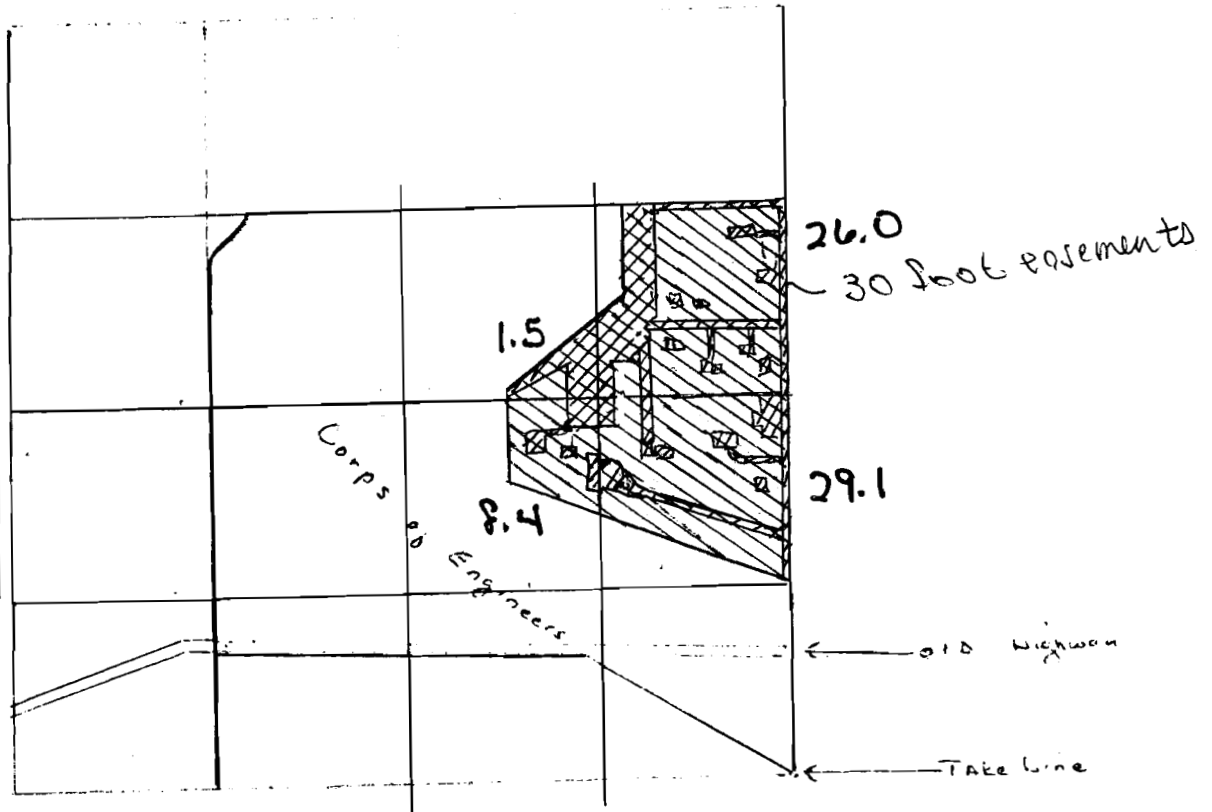

T5N R26E Section 22	Original Permit W/R Acres	2000 Amendment W/R Acres Transferred		2001 Amendment W/R Acres Transferred		Total W/R Acres  After Transfer
		Off	On	Off	On	
1/4 1/4						
SW NE	5.0			3.5		1.5
SE NE	38.0			12.0		26.0
NE SE	34.4			5.3		29.1
NW SE	10.0			1.6		8.4
<b>TOTAL</b>	<b>87.40</b>			<b>22.4</b>		<b>65.0</b>

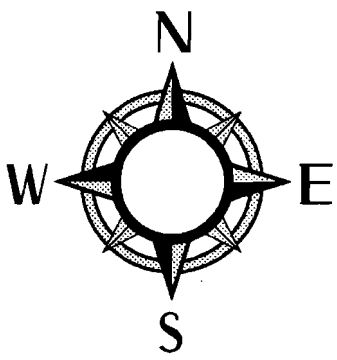

**WEST EXTENSION IRRIGATION DISTRICT  
WATER RIGHT TRANSFER MAP  
AMENDMENT TO PERMIT NO. 45999  
2001**

**RECEIVED**  
AUG 07 2001  
WATER RESOURCES DEPT  
SALEM, OREGON

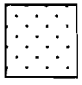
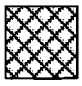

Scale 1" = 1320'

**Legend**

-  Existing Permit
-  Transferred On 2000
-  Transferred Off 2001
-  Transferred On 2001
-  Trailer Park-50% Irrigated Roads = 30' each 1/4 1/4

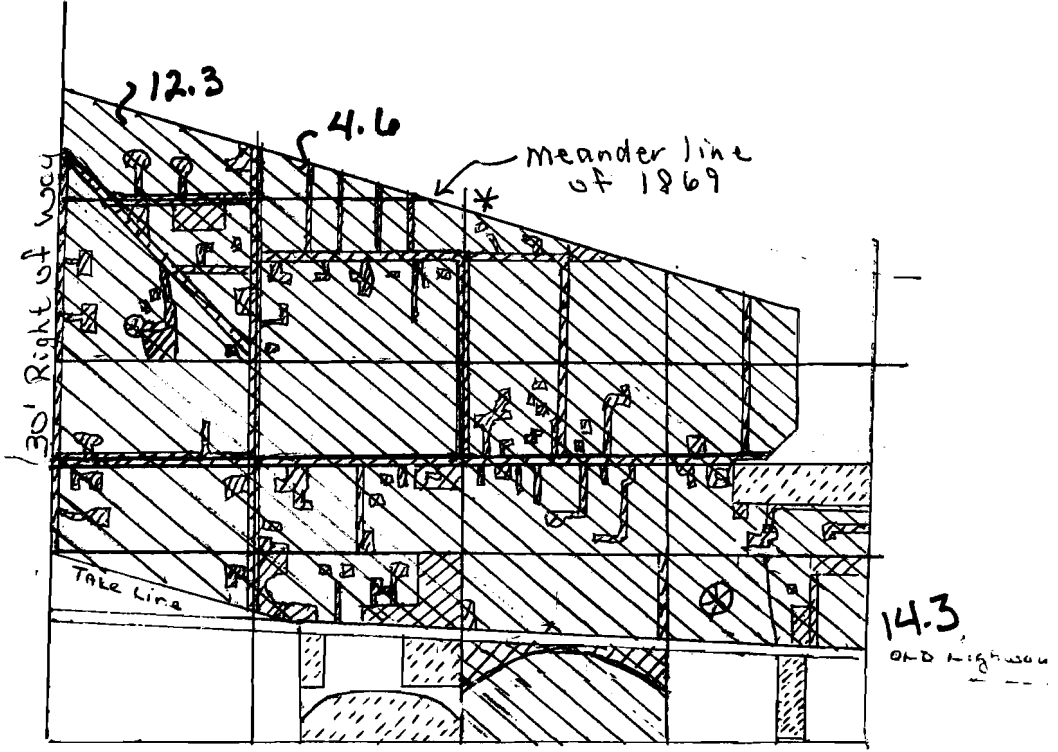

\*Increase due to Meander Line correction (Original Permit was in error)

T5N R26E Section 23 1/4 1/4	Original Permit W/R Acres	2000 Amendment W/R Acres Transferred		2001 Amendment W/R Acres Transferred		Total W/R Acres After Transfers
		Off	On	Off	On	
SW NE	23.0			0.8	2.0*	24.2
SE NE	11.0			1.0		10.0
NE NW	5.0			0.4		4.6
NW NW	15.0			2.7		12.3
SW NW	35.0			9.7		25.3
SE NW	35.0			8.7		26.3
NE SW	40.0			7.3		32.7
NW SW	40.0			6.4		33.6
SW SW	6.0			1.0		5.0
SE SW	16.0			8.8	11.6	18.8
NE SE	29.0			6.0	5.7	28.7
NW SE	40.0			7.0		33.0
SW SE	36.0			3.2		32.8
SE SE	19.0			7.4	2.7	14.3
<b>TOTAL</b>	<b>350.0</b>	<b>0.0</b>	<b>0.0</b>	<b>70.4</b>	<b>22.0</b>	<b>301.6</b>

RECEIVED

AUG 07 2001

WATER RESOURCES DEPT  
SALEM, OREGON

WEST EXTENSION IRRIGATION DISTRICT  
WATER RIGHT TRANSFER MAP  
AMENDMENT TO PERMIT NO. 45999  
2001

Scale 1" = 1320'

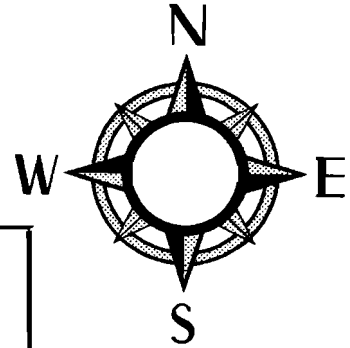

Legend	
	Existing Permit
	Transferred off 2000
	Transferred off 2001
	Transferred on 2001

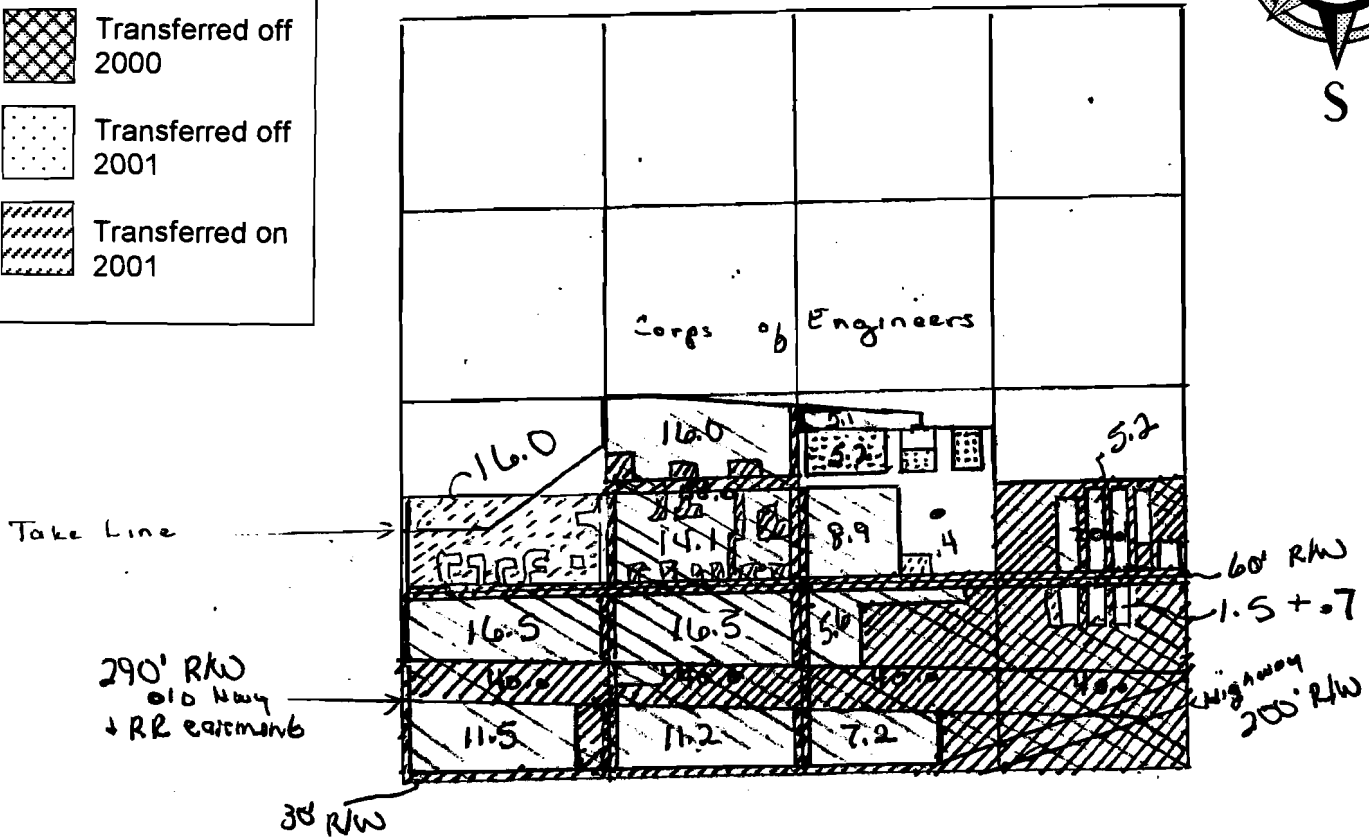

T5N R26E Section 24 1/4 1/4	Original Permit W/R Acres	2000 Amendment W/R Acres Transferred		2001 Amendment W/R Acres Transferred		Total W/R Acres After Transfer
		Off	On	Off	On	
NE SW	38.0	4.4		3.5		30.1
NW SW	0.0				16.0	16.0
SW SW	40.0	12.0				28.0
SE SW	40.0	12.3				27.7
NE SE	20.0	14.8				5.2
NW SE	12.2	1.2	5.2		0.4	16.6
SW SE	40.0	27.2				12.8
SE SE	40.0	38.5				1.5
<b>TOTAL</b>	<b>230.2</b>	<b>110.4</b>	<b>5.2</b>	<b>3.5</b>	<b>16.4</b>	<b>137.9</b>

RECEIVED

SEP 24 2001



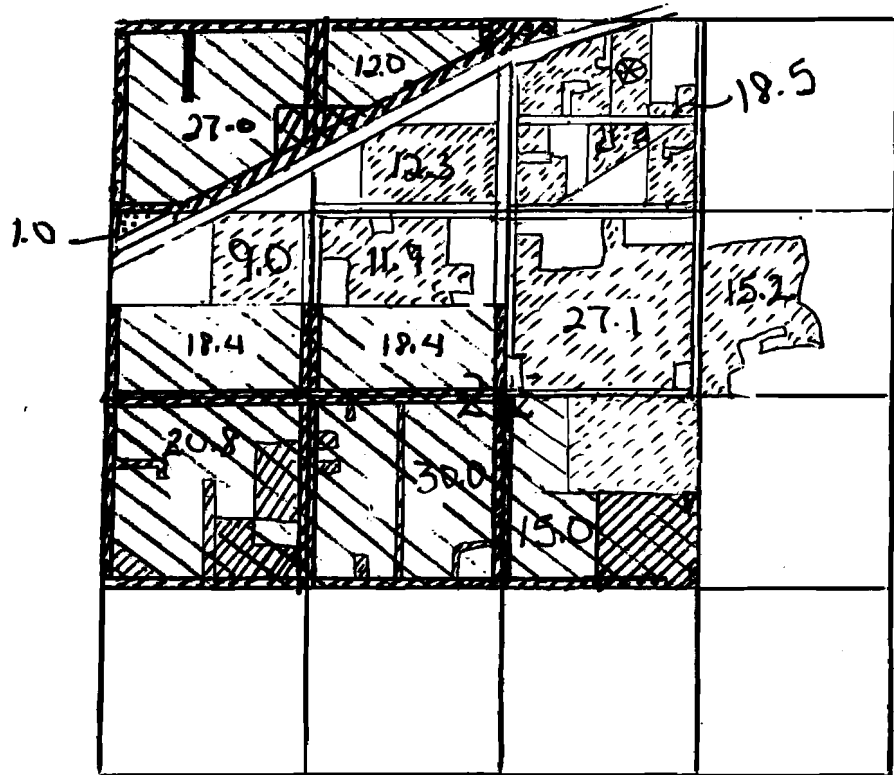
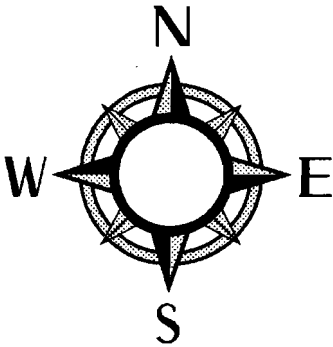

WATER RESOURCES DEPT.  
SALEM, OREGON

**WEST EXTENSION IRRIGATION DISTRICT  
WATER RIGHT TRANSFER MAP  
AMENDMENT TO PERMIT NO. 45999  
2001**

Scale 1" = 1320'

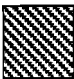

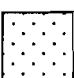
**Legend**

-  Existing Permit
-  Transferred off 2000
-  Transferred On 2000
-  Transferred On 2001
-  Trailer Park-40% Irrigated

Roads = 30' each 1/4 1/4

T5N R26E Section 25 1/4 1/4	Original Permit W/R Acres	2000 Amendment W/R Acres Transferred		2001 Amendment W/R Acres Transferred		Total W/R Acres After Transfers
		Off	On	Off	On	
NW NE	3.0	3.0			18.5	18.5
SW NE					27.1	27.1
SE NE					15.2	15.2
NE NW	18.0	6.0			12.3	24.3
NW NW	37.0	10.0				27.0
SW NW	20.0	1.6	1.0		9.0	28.4
SE NW	20.0	1.6			11.9	30.3
NE SW	40.0	3.2		6.8		30.0
NW SW	40.0	3.2		16.0		20.8
NW SE	40.0	11.2		13.8		15.0
<b>TOTAL</b>	<b>218.0</b>	<b>39.8</b>	<b>1.0</b>	<b>36.6</b>	<b>94.0</b>	<b>236.6</b>



RECEIVED

AUG 07 2001



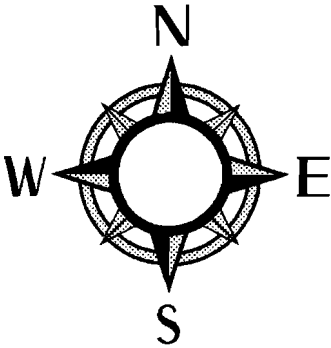

WATER RESOURCES DEPT  
SALEM, OREGON

WEST EXTENSION IRRIGATION DISTRICT  
WATER RIGHT TRANSFER MAP  
AMENDMENT TO PERMIT NO. 45999  
2001

Scale 1" = 1320'



**Legend**

-  Existing Permit
-  Transferred off 2000
-  Transferred On 2000
-  Transferred On 2001

Roads = 30' each ¼ ¼

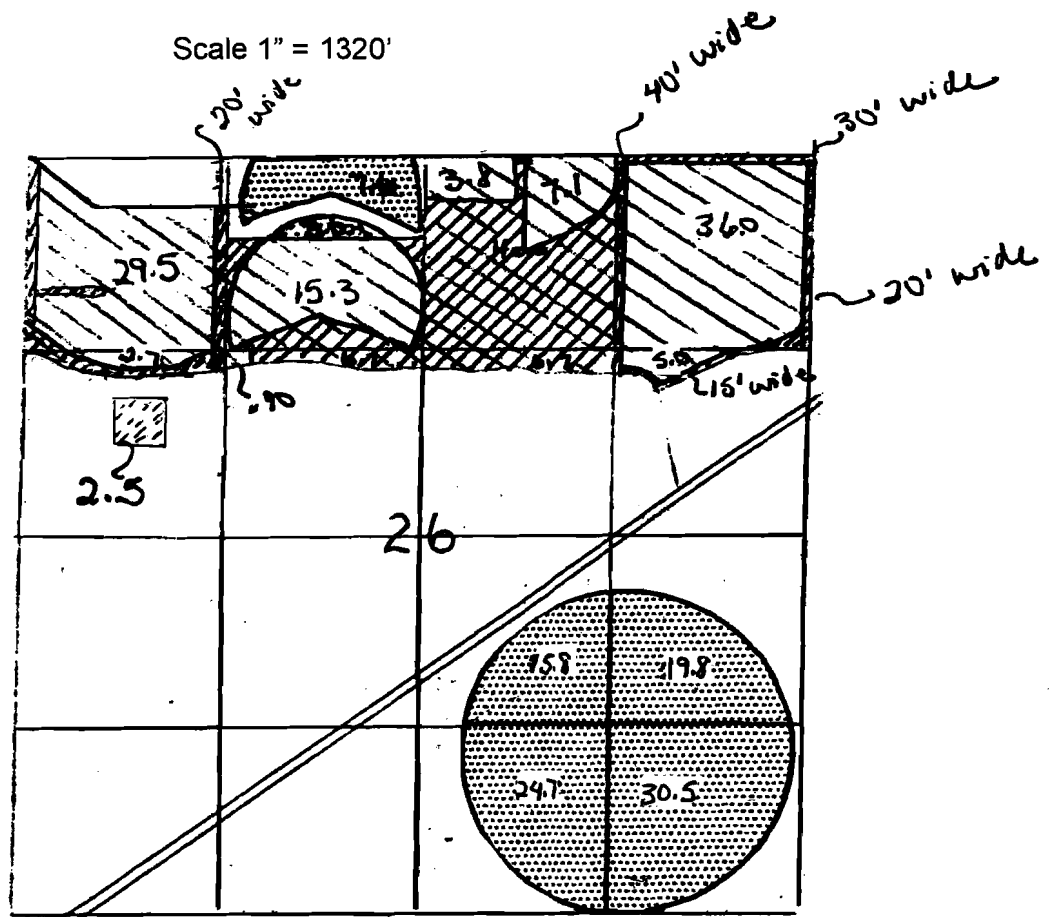

T5N R26E Section 26 1/4 ¼	Original Permit	2000 Amendment W/R Acres Transferred		2001 Amendment W/R Acres Transferred		Total W/R Acres After Transfers
	W/R Acres	Off	On	Off	On	
NE NE	40.0	3.0		1.0		36.0
NW NE	40.0	29.1				10.9
SW NE	6.7	6.7				0.0
SE NE	6.1	1.1				5.0
NE NW	25.0	9.7	10.6			25.9
NW NW	32.0	1.5		1.0		29.5
SW NW	6.3	3.6			2.5	5.2
SE NW	6.7	5.8				0.9
NE SE			19.8			19.8
NW SE			15.8			15.8
SW SE			24.7			24.7
SE SE			30.5			30.5
<b>TOTAL</b>	<b>162.8</b>	<b>60.5</b>	<b>101.4</b>	<b>2.0</b>	<b>2.5</b>	<b>204.2</b>