

T.37 & 38 S., R.5W., W.M.

FEB 27 1987

WM. DIST. 14
GRANTS PASS, ORE.

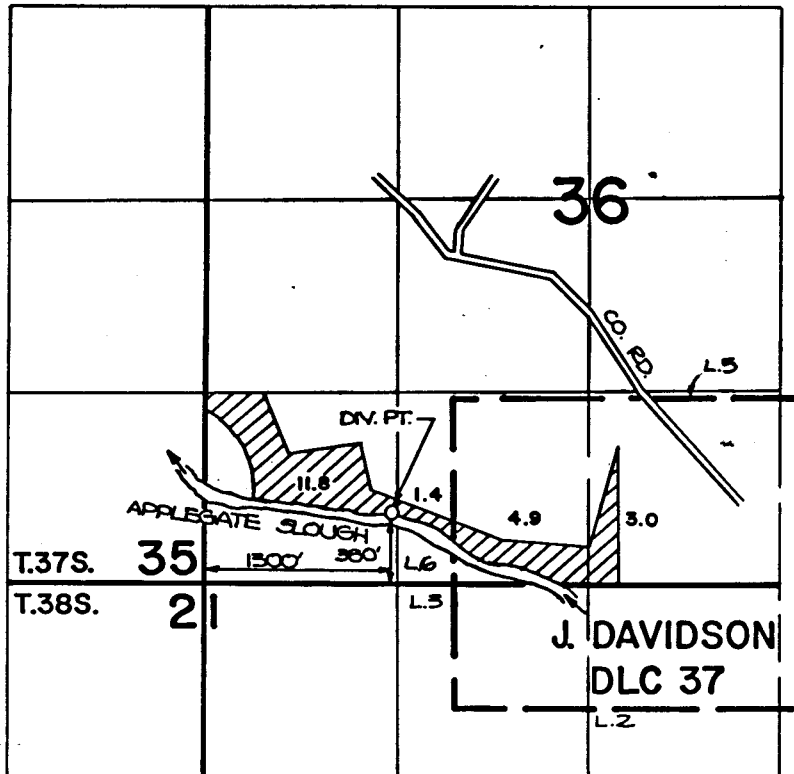

FINAL PROOF SURVEY

UNDER

Application No. ~~57447~~ 62209 Permit No. ~~43268~~ 46080
IN NAME OF

.....**JERRY NOBLE**.....

Surveyed **APR 29**, 1982, by ...**B. SUND**.....