

T.37S. R.5W. W.M.

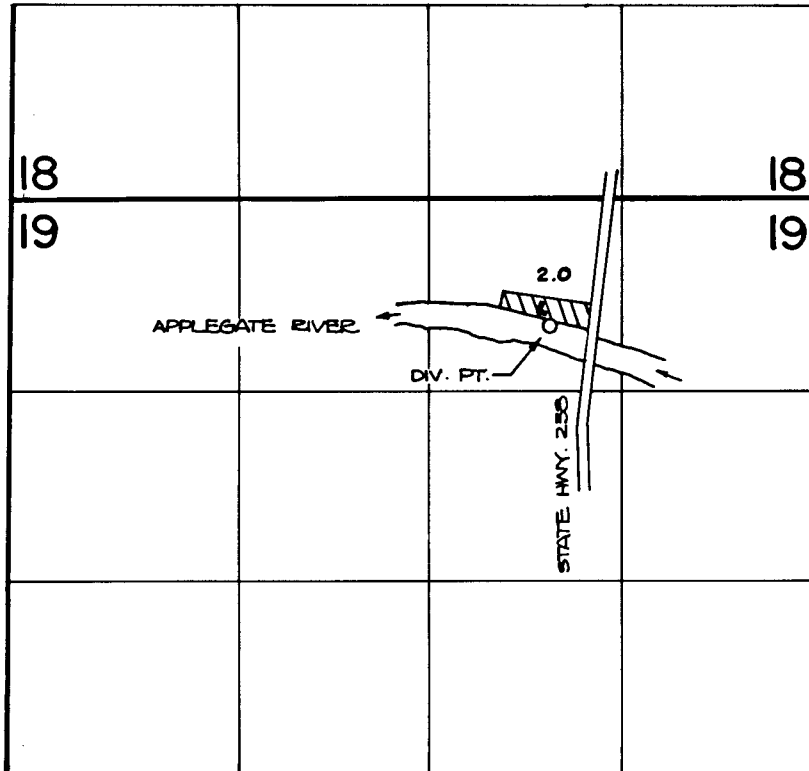

DIVERSION POINT IS LOCATED 800'S. AND 900' E. FROM THE N. 1/4 CORNER OF SECTION 19.

RECEIVED

MAR 20 1987

WM DIST. 14
GRANTS, N.M., U.S.A.

FINAL PROOF SURVEY
UNDER

Application No. **62367** Permit No. **46090**
IN NAME OF

LOLA M. CLOSE

Surveyed **MAY 14** 19**82**, by **B. SUND**