

T.37S.,R.5W.,W.M.

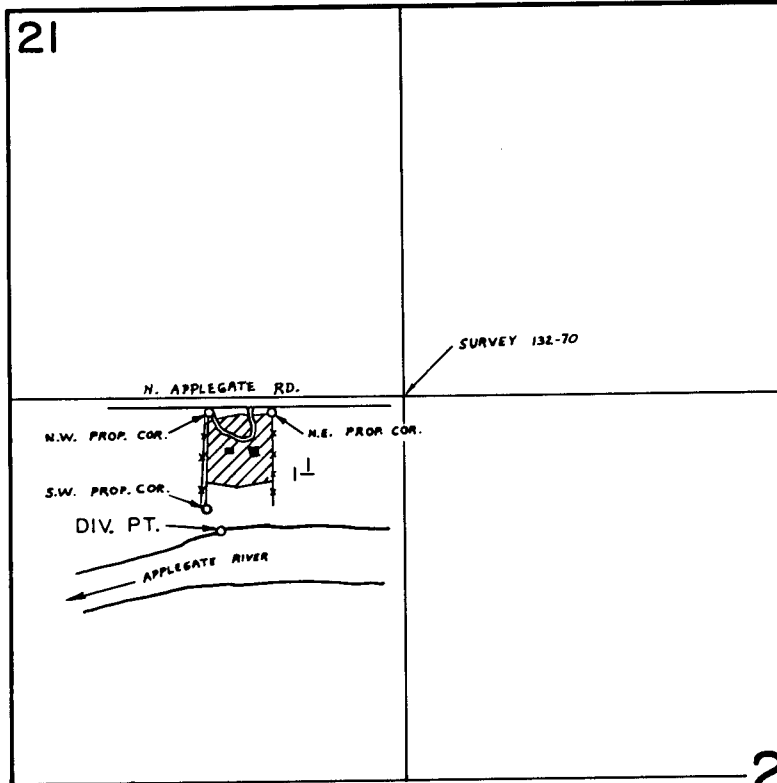

RECEIVED

MAR 29 1987

REG. DIST. 14
GRANT BLDG. 100

21

DIV. PT. LOC.: 460' S. & 625' W. FROM N.E. COR. OF SW. 1/4 N.W. 1/4 SEC. 21.
SCALE: 1" = 660'

FINAL PROOF SURVEY
UNDER

Application No. 61854... Permit No. 46135...
IN NAME OF

JONATHAN D. & MARY LAZETTE AHLROTH

Surveyed OCT. 17, 1977, by B. SUND.....
MARCH 29, 1982

PTS 1977-14-B