

T.17S. R.9E. 33 34
 T.18S. R.9E. 4 3

NORTH
 5280'

4 3
 9 10

NORTH
 5280'

9 10
 16 15

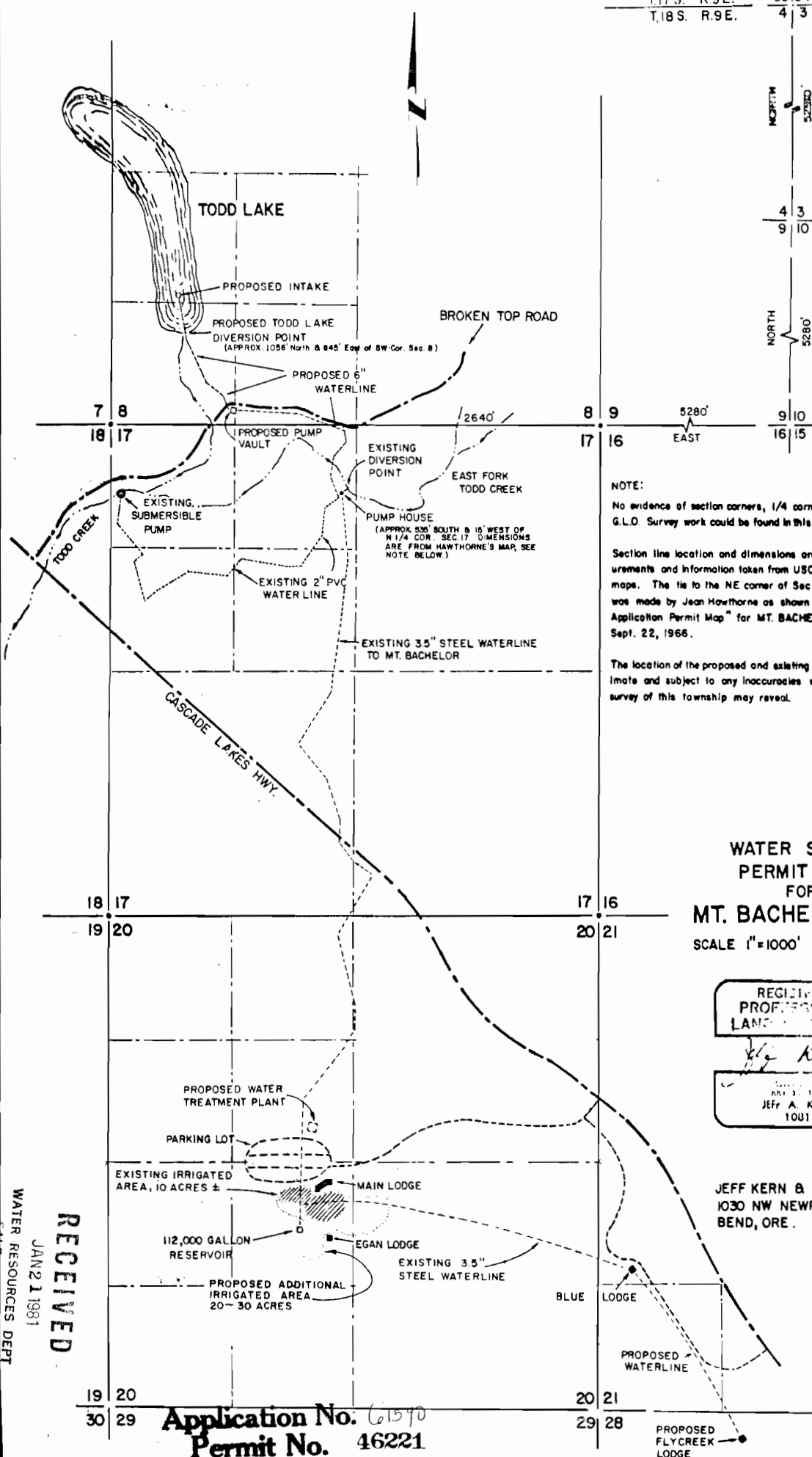

NOTE:

No evidence of section corners, 1/4 corners or original G.L.D. Survey work could be found in this area.

Section line location and dimensions are based on measurements and information taken from USC & GS topographic maps. The tie to the NE corner of Section 4, T.18S., R.9E. was made by Jean Hawthorne as shown on his "Water Application Permit Map" for MT. BACHELOR INC. dated Sept. 22, 1966.

The location of the proposed and existing waterline is approximate and subject to any inaccuracies which a subsequent survey of this township may reveal.

WATER SYSTEM PERMIT MAP FOR MT. BACHELOR INC.

SCALE 1"=1000' NOV. 1980

REGISTERED PROFESSIONAL LAND SURVEYOR

Jeff Kern
 JEFF A. KERN
 1001

JEFF KERN & ASSOC. INC.
 1030 NW NEWPORT AVE.
 BEND, ORE.

RECEIVED
 JAN 21 1981
 WATER RESOURCES DEPT
 OREGON

Application No. 61570
 Permit No. 46221