

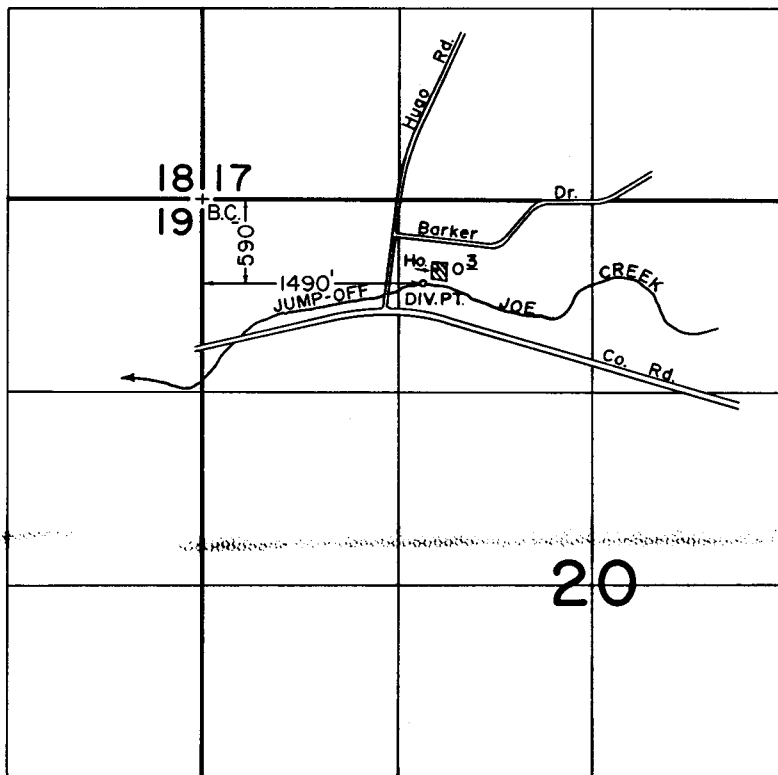

T. 35 S., R. 6 W., W.M.



RECEIVED

OCT 31 1990

W.M. DIST. 14  
GRANTS PASS, ORE

SCALE: 1" = 1320'

**FINAL PROOF SURVEY**  
UNDER

Application No. 60328... Permit No. 46288.....  
IN NAME OF

CHARLES HENNING PETERSEN

Surveyed MAY 15.... 1989., by B. S. JAMES.....

11-22-89  
41033-179-149L *JS*