

RECEIVED

AUG 17 1981

WATER RESOURCES DEPT
SALEM, OREGON

T. 2 N. R. 33 E.

Sec. 8

NW 1/4 NW 1/4

Application No. R-62332 &
62333

Permit No. R 8375 46543

M

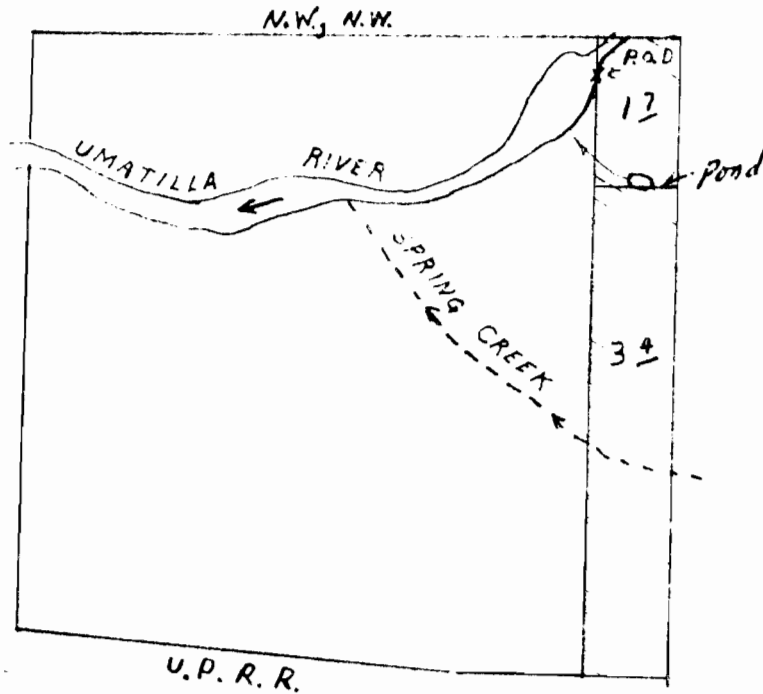

P.O.D. Location: 1200 ft E. & 100 ft S.
from N.W. Cor. Sec. 8

Spring Pond Located 1250 ft E. & 300 ft S.
from N.W. Cor. Sec. 8

Scale: 1" = 400'

MAILED
WATER RESOURCES DEPT
SALEM, OREGON