

I, J. P. DeWitt, of Alameda,  
Oregon, do hereby certify that  
this map was made from notes  
taken during an actual survey  
made by me on June 14, 1920, and  
that it correctly represents  
the works described in the ac-  
companying application, together  
with the location of streams and  
other ditches in the immediate  
vicinity.

J. P. DeWitt  
Surveyor.

Scale, 2" = 1 Mi.

T. 34 S. R. 8 W. W. M.

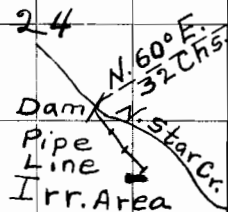

Profile of Dam  
1" = 8'

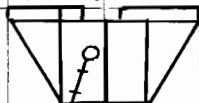

Pipe Line  
Entrance

Application No. 7348

Permit No. 4655