

T. 22 S. R 47 E. W.M.

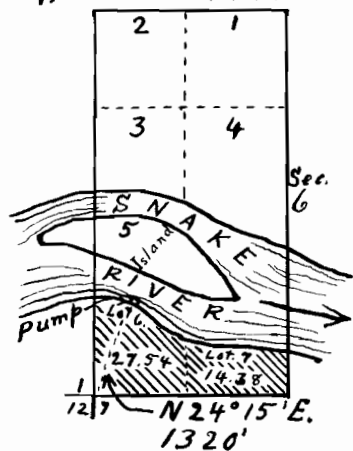

I, John E. Johnson, of VALE, OREGON, do hereby certify that this map was made from notes and data furnished me by applicant, and that it correctly represents the works described in the accompanying application.

The applicant didn't feel justified in going to the expence of getting an engineer from a long distance so obtained her own measurements which I believe to be practically correct.

June 23. 1920.

John E. Johnson  
Surveyor.

### M A P

Accompanying application for  
permit to appropriate water

Mary H. Napton

Homedale, Idaho.

June 23. 1920.

7373  
4668