

THIS MAP WAS PREPARED FOR
ASSESSMENT PURPOSES ONLY

NW1/4 NE1/4 SECTION 16 T.3S. R.7E. W.M.
CLACKAMAS COUNTY
1" = 100'

3 7E 16AB



SEE MAP 3 7E 9CD

SEE MAP 3 7E 9

CANCELLED TL'S
F00
2300

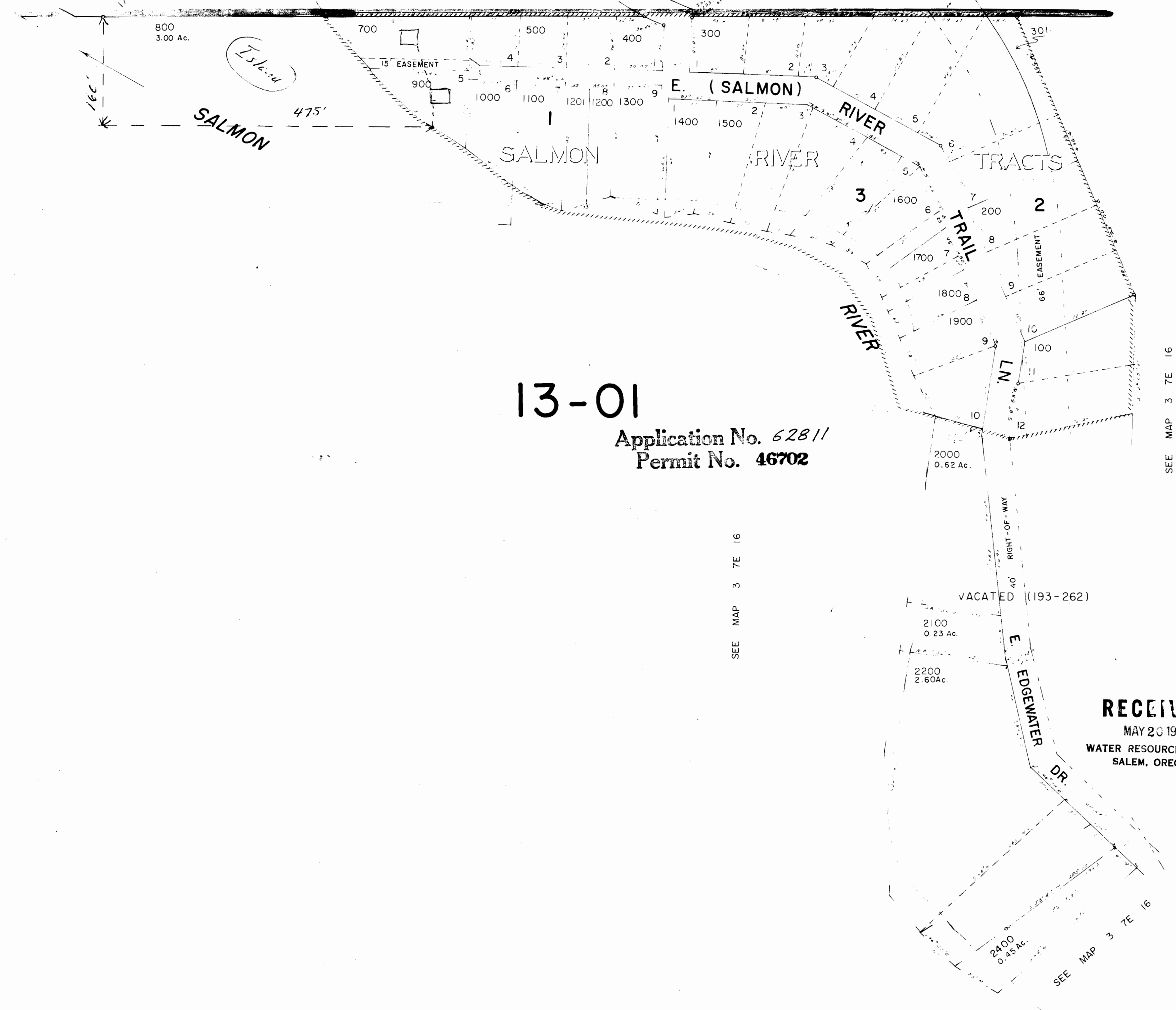

13-01

Application No. 62811
Permit No. 46702

SEE MAP 3 7E 16

SEE MAP 3 7E 16

VACATED (193-262)

RECEIVED
MAY 20 1982
WATER RESOURCES DEPT
SALEM, OREGON

SEE MAP 3 7E 16

3 7E 16AB
BOOK 34

Comp. 4-1-87 G.M.