

Appraiser's Initials \_\_\_\_\_

**PLAT OF FARM**

No. \_\_\_\_\_  
Use Standard Legend. Indicate roads and show direction and distance to nearest town. Indicate points of compass—show scale of map. Designate section numbers at section centers. If more than one source of irrigation supply, indicate area served by each.

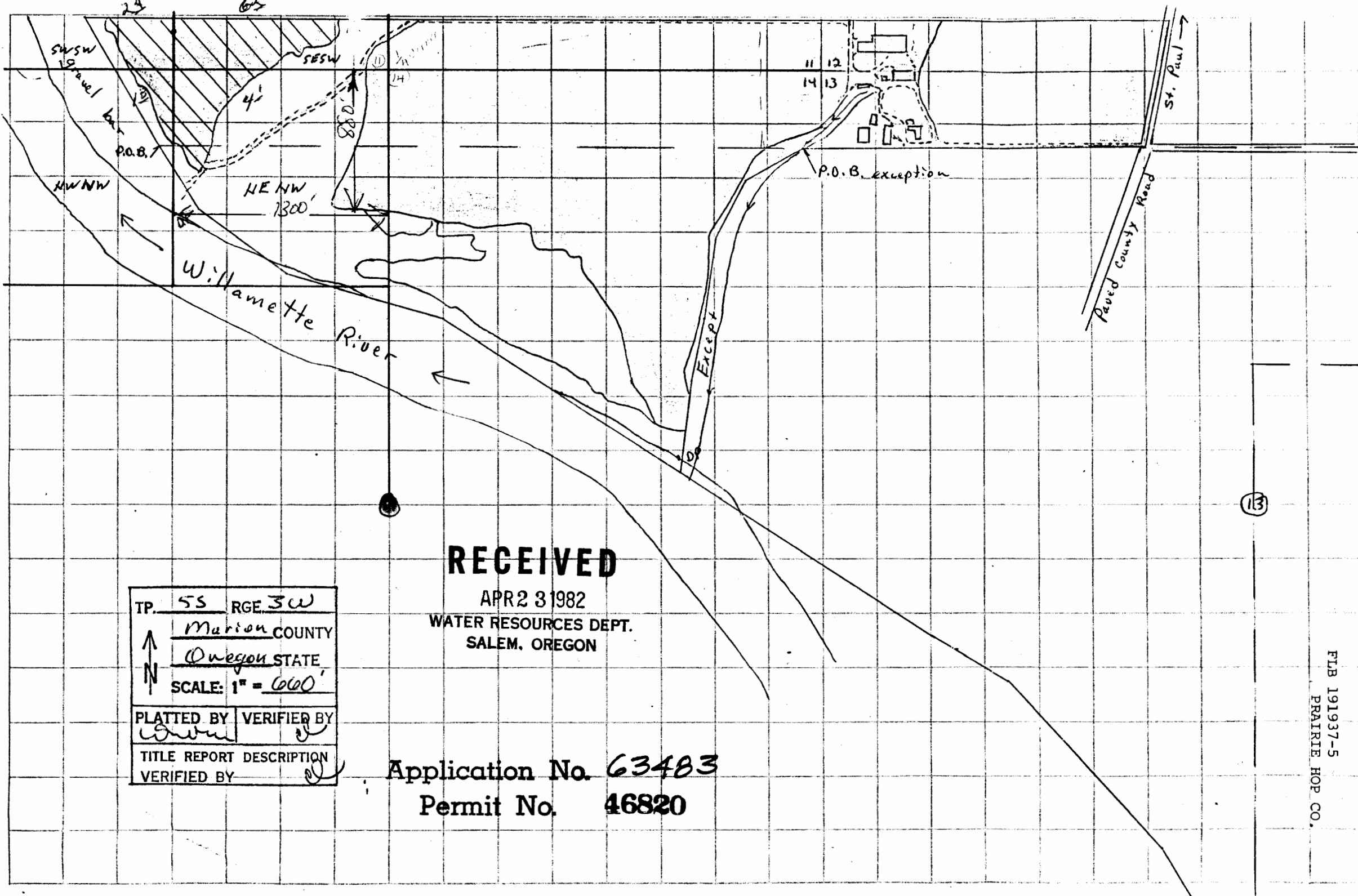

TP. 5S RGE 3W	
Marion COUNTY	
Oregon STATE	
SCALE: 1" = 660'	
PLATTED BY <i>[Signature]</i>	VERIFIED BY <i>[Signature]</i>
TITLE REPORT	DESCRIPTION
VERIFIED BY <i>[Signature]</i>	

**RECEIVED**

APR 23 1982  
WATER RESOURCES DEPT.  
SALEM, OREGON

Application No. **63483**  
Permit No. **46820**

(13)