

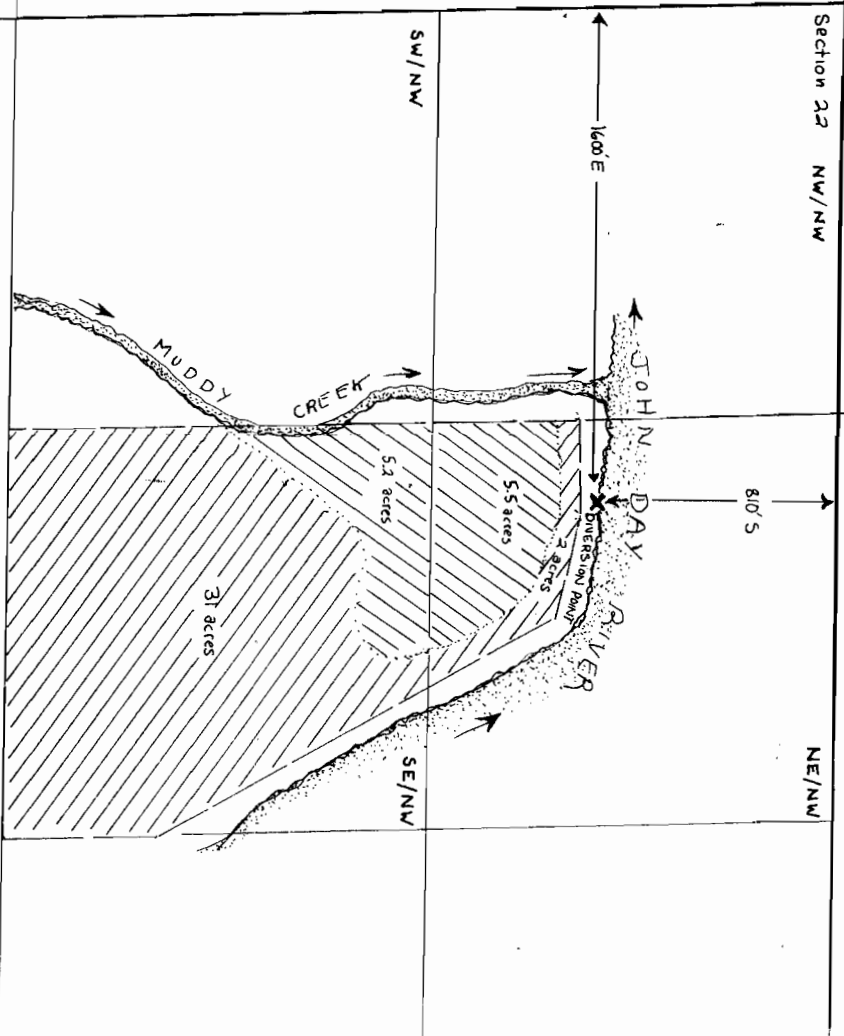

Section 16
Section 15

Section 21
Section 22

NW/NW
NE/NW

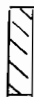

 Irrigation Acreage
 Acreage from Permit No. 41412

T8S R. 19E W.M.

B.L.M.

Application No. 63606
Permit No. 46859

RECEIVED
JUN 8 1982
WATER RESOURCES DEPT
SALEM, OREGON

RAJNEESH NEO-SANNIVAS INTERNATIONAL COMPANY
 P.O. Box 12A, Antelope, OR 97001 (503) 861-1111
 MAP FOR APPLICATION TO APPROPRIATE
 SURFACE WATER - JOHN DAY RIVER