

T. 9S., R. 27E., W.M.

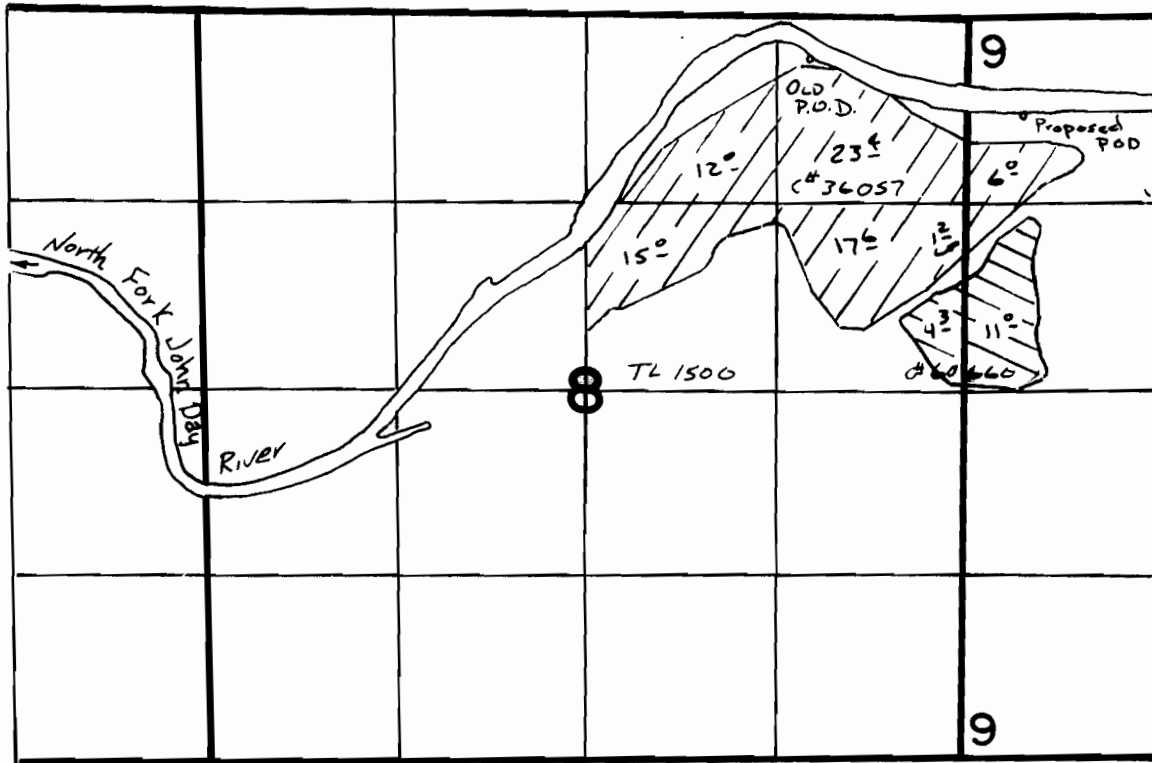

OLD P.O.D. LOCATED 350'S & 1100'W. FROM NE CORNER, SECTION 8
 PROPOSED P.O.D. LOC: 670'S. & 400'E FROM NE CORNER, SECTION 8

Scale 1" = 1320'

TRANSFER APPLICATION MAP

CHANGE IN POINT OF DIVERSION

FOR

TROPHY LAND MANAGEMENT

THIS MAP WAS PREPARED BY V. CHURCH,
 WATERMASTER, DIST. 21, OWRD UNDER
 THE DIRECTION OF GARY BALL, CWRE,
 OWRD

WE AGREE WITH THE INFORMATION
 AND LOCATIONS ON THE MAP AND
 APPLICATION FOR TRANSFER.

Deanne L. Hedworth, Jr
 TROPHY LAND MANAGEMENT

Gary Ball
 CWRE
 12/31/01

GARY BALL, CWRE

T-9631

THE PURPOSE OF THIS MAP IS FOR IDENTIFYING THE LOCATION OF THE
 LOCATION OF THE WATER RIGHT ONLY AND IS NOT INTENDED TO PROVIDE
 LEGAL DIMENSIONS OR LOCATION OF PROPERTY OWNERSHIP LINES.