

T.34S., R.5W., W.M.

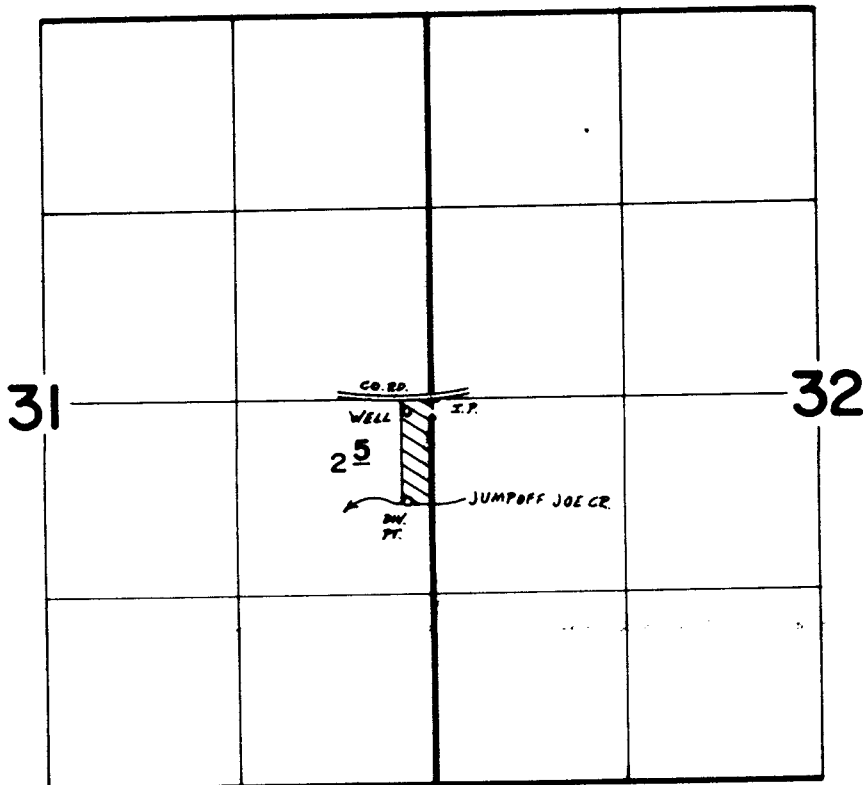

RECEIVED

MAR 23 1990

WTA DIST. 14
GRANTS PASS, OR

SCALE 1" = 1320'

DIV. PT.: 700'S @ 180'W FROM E 1/4 COR. SEC. 31.
WELL: 60'S @ 180'W FROM E 1/4 COR. SEC. 31.

FINAL PROOF SURVEY UNDER

64624 47345
Application No. G-10862 Permit No. G-10011....
IN NAME OF

..... IRVING W. JOHNSON

Surveyed JULY 12, 1984, by B.S. JAMES.....

41033-179-153R

li