

T 185 R 8W  
1" = 400'

ELECTRIC  
1RB

Application No. 63498  
Permit No. 47361

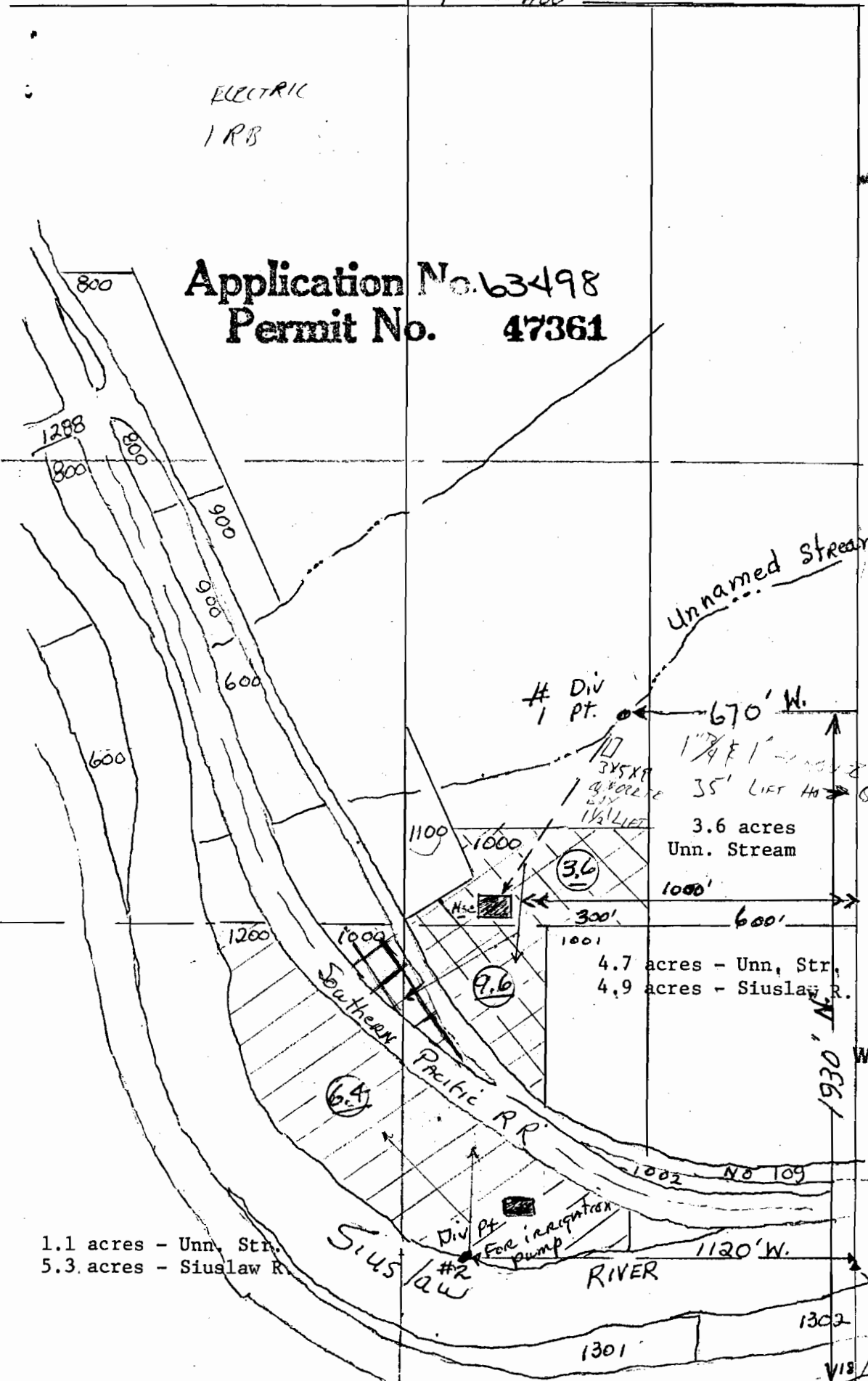

**RECEIVED**  
FEB 3 1983  
WATER RESOURCES DEPT.  
SALEM, OREGON

**RECEIVED**  
APR 29 1982  
WATER RESOURCES DEPT.  
SALEM, OREGON

1.1 acres - Unn. Str.  
5.3 acres - Siuslaw R.

1302 360' N.  
1930' N.  
1000' 600' 300' 1000'  
1200' 1000' 1100' 1000' 1288 800  
1301 1302 1120' W. 360' N. 1930' N. 1000' 600' 300' 1000'  
1200' 1000' 1100' 1000' 1288 800  
1301 1302 1120' W. 360' N. 1930' N. 1000' 600' 300' 1000'  
1200' 1000' 1100' 1000' 1288 800