

T. 39 S., R. 8 W., W.M.

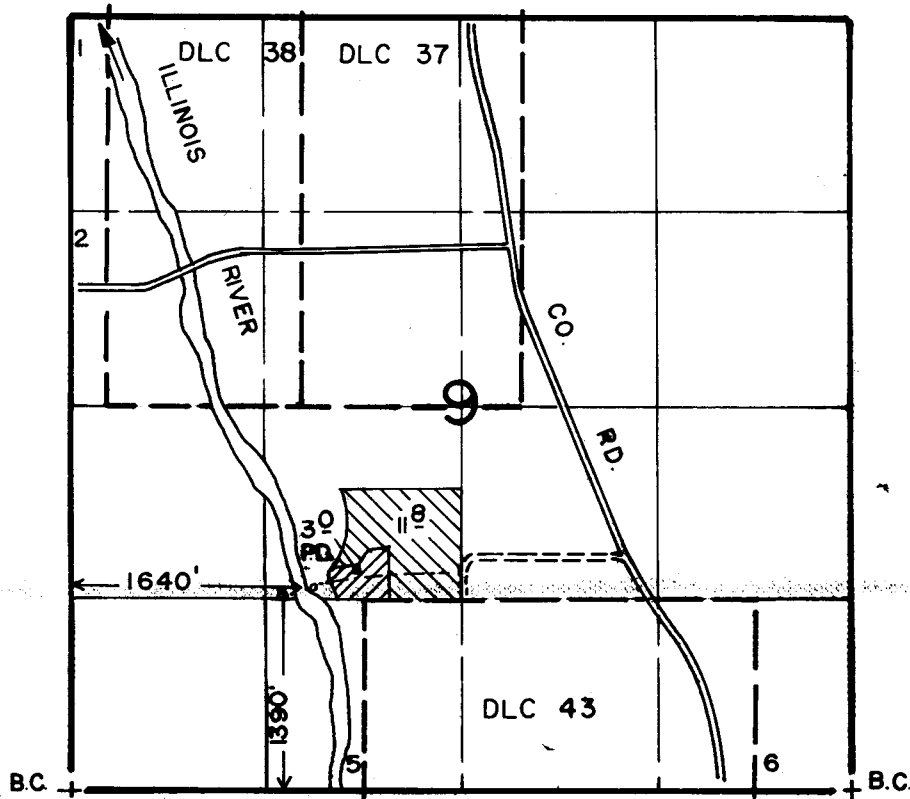

1" = 1320'

RECEIVED

NOV 30 1990

**FINAL PROOF SURVEY
UNDER**



W.M. DIST. 14
PRIMARY PASS, ORE.



SUPPLEMENTAL

Application No. 64849 Permit No. 47637
IN NAME OF

MILDRED L. FRICK

Surveyed MAY 22 1990, by B.S. JAMES

7-25-90 DSM
41033-179-232 R