

T. 35 S., R. 7 W., W. M.

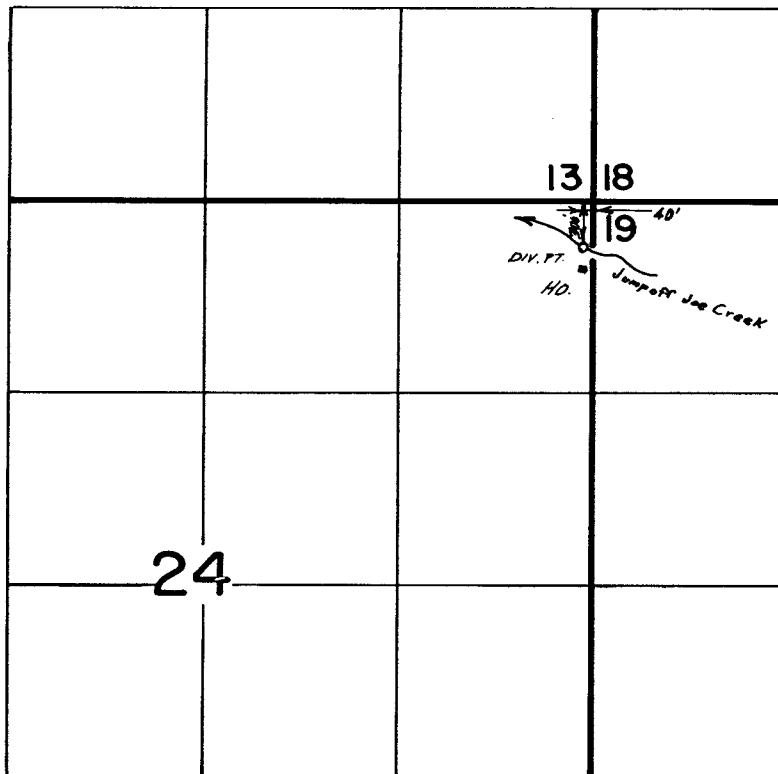

Scale 1" = 1320'

RECEIVED

JUL 18 1991

WM. DIST. 14  
GRANTS PASS, ORE.

**FINAL PROOF SURVEY**  
UNDER

Application No. 66026 Permit No. 48050  
IN NAME OF

MARY L. SOARES

Surveyed Nov. 4, 1987, by B.S. JAMES