

T.37 S., R.9 W., W.M.

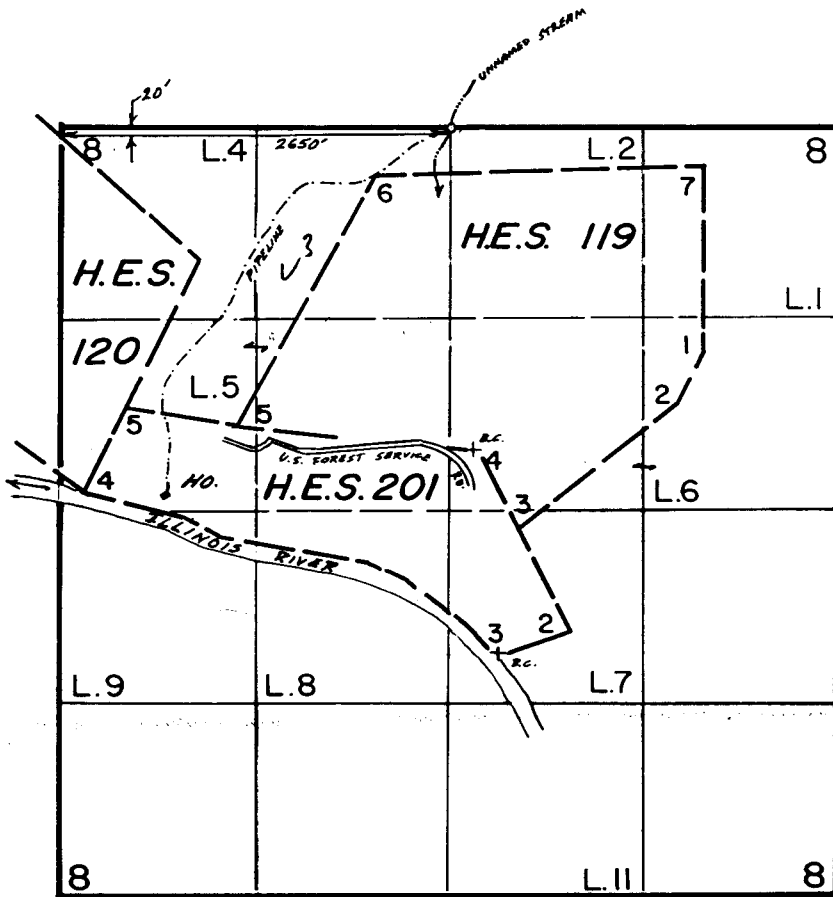

Scale 1" = 1320'

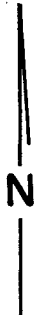

RECEIVED

JUL 23 1990

WM. DIST. 14
GRANTS PASS. ORE.

FINAL PROOF SURVEY UNDER

Application No. 65585.. Permit No. 48068.....
IN NAME OF

.....ROLF SOMMER.....

Surveyed Nov. 17., 1987., by B.S. JAMES.....