

T.15 S., R. 31 E., W.M.

RECEIVED

OCT 3 1983

APPLICATION MAP FOR
ROBERT & VERA MARTIN

WATER RESOURCES DEPT.
SALEM, OREGON

Application No. 67321
Permit No. 48150

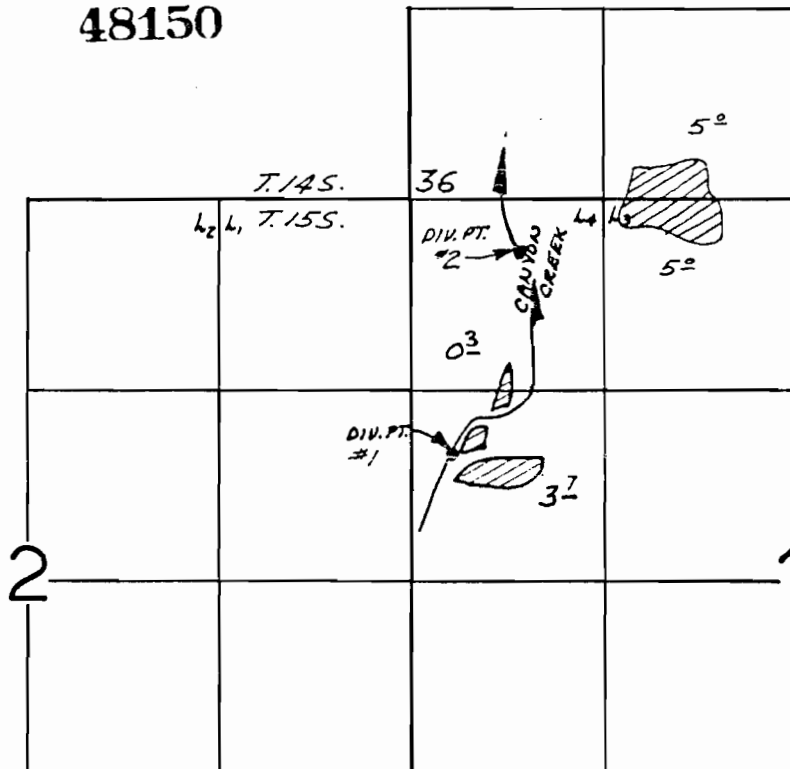

SCALE
4" = 1 mi

approved

POD#1 is 1750 ft S & 270 ft E of NW corner Section 1.

POD#2 is 370 ft S & 750 ft E of NW corner Section 1.

