

Application No. 67442

Permit No. 48197

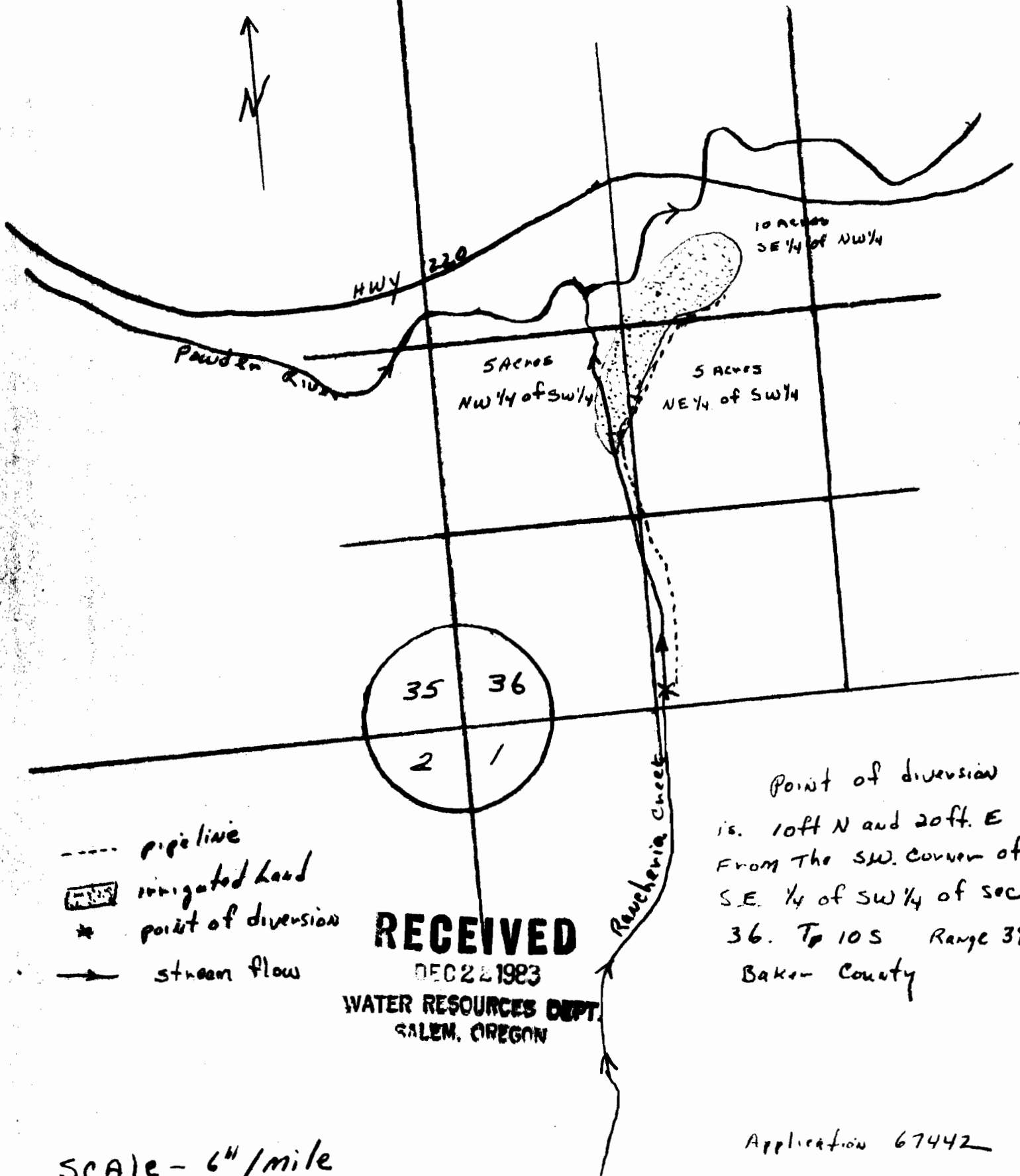

RECEIVED
 DEC 22 1983
 WATER RESOURCES DEPT.
 SALEM, OREGON

Point of diversion
 is. 10ft N and 20ft. E
 From the SW. corner of
 S.E. 1/4 of SW 1/4 of sec
 36. T_{10S} Range 39E
 Baker County

SCALE - 6" / mile
 1" = 880'

Application 67442