

T.3 S. R. 40 E W.M.
Union County
Sec 8

RECEIVED

DEC 19 1983

WATER RESOURCES DEPT.
SALEM, OREGON

C 98¹



Application No. 67988
Permit No. 48252

RECEIVED

JAN 10 1978

WATER RESOURCES DEPT.
SALEM, OREGON

F

E 85

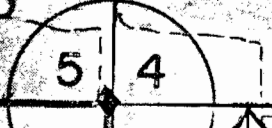

~~Application No. 51701~~
~~Permit No. 40001 R 6755~~

2270'

2516'

2640' NE CORNER
SOUTH OF CORNER
OF SECTION 8

1320'

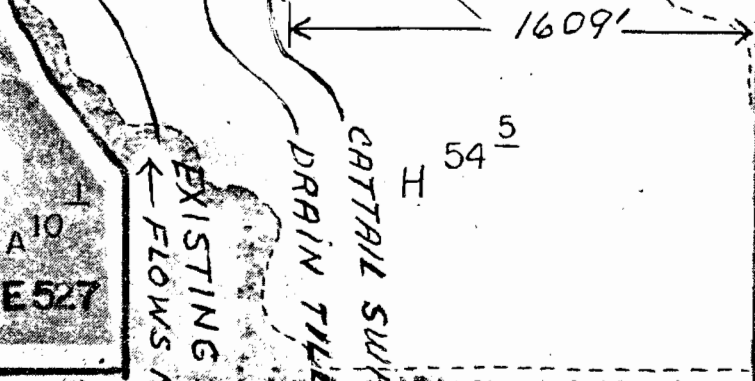
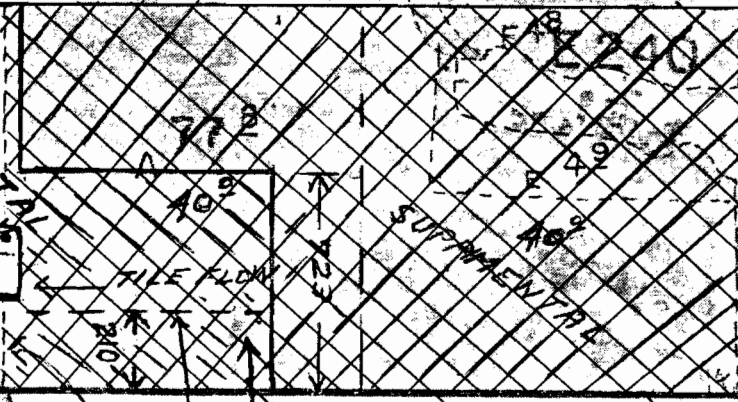

E 539

E 535

E 536

E 537

E 538

H 54⁵

RECEIVED