

T 13 S., R. 30 E., W M  
Sec 15

Application Map for  
Roy Kilpatrick

RECEIVED  
OCT 14 1983  
WATER RESOURCES DEPT.  
SALEM, OR.

Application No. 67920  
Permit No. 48299

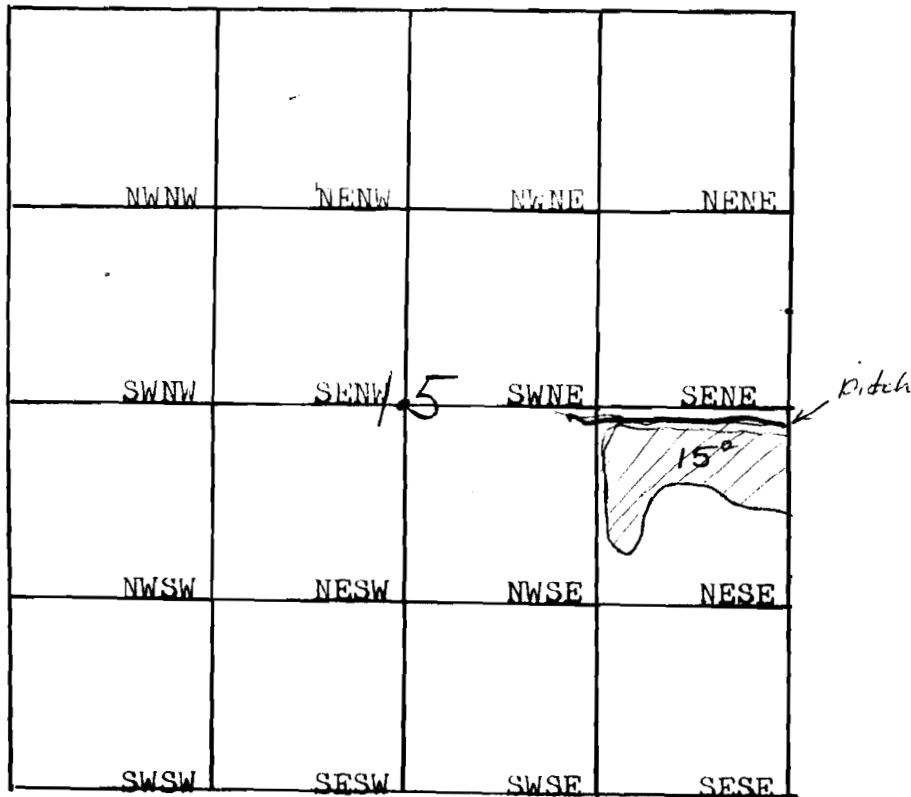

Scale: 4" - 1 Mile  
1" - 1320 Ft.

T13.S., R.30E., W.M.  
Sec 14

Application map for  
Roy Kilpatrick

RECEIVED

OCT 14 1983

WATER RESOURCES DEPT.  
SALEM, OR.

Application No. 67920  
Permit No. 48299

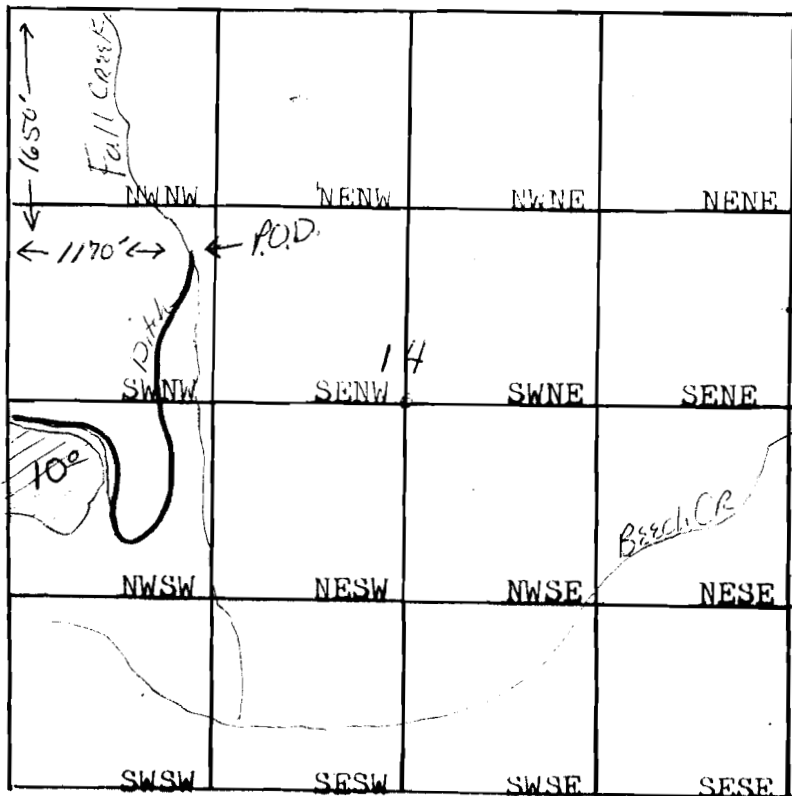

Scale: 4" - 1 Mile  
1" - 1320 Ft.