

T. 37S. R. 1W. W. M.

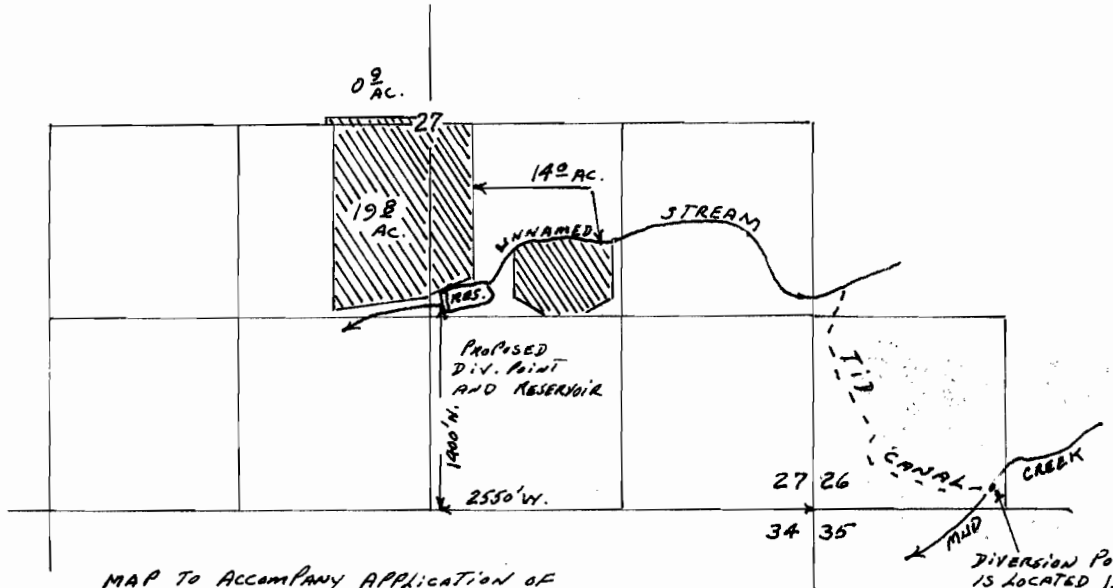

MAP TO ACCOMPANY APPLICATION OF
CRYSTAL SPRINGS PACKING CO.
% JUANNE CALBERTSON FOR RESERVOIR
AND TEMP. CONTROL

DIVERSION POINT
IS LOCATED 150' N.
AND 1250' E. FROM
THE SW COR. OF
SEC. 26.

Application No. ^{R-58686}
58687
Permit No. R 9684
48399

RECEIVED
MAY 21 1979
WATER RESOURCES DEPT.
SALEM, OREGON

SCALE 4" = 1 MILE

THIS MAP PREPARED BY:

John F. Cummings

FROM INFORMATION FURNISHED BY
THE APPLICANT.

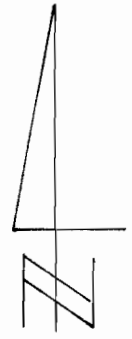

5-16-79