

RECEIVED

NOV 9 1982

WATER RESOURCES DEPT.
SALEM, OREGON

RECEIVED

MAR 2 1983

WATER RESOURCES DEPT.
SALEM, OREGON

- 1. HOUSE, GARDEN, LAWN, DOMESTIC
- 2. HOUSE, GARDEN, LAWN, DOMESTIC
- 3. LABOR CAMP, WASH HOUSE, DOMESTIC

McISAAC

- 4. HOUSE, GARDEN, LAWN, DOMESTIC
- 5. HOUSE, GARDEN, LAWN, DOMESTIC
- 6. WAREHOUSE
- 7. HOUSE, GARDEN, LAWN, DOMESTIC
- 8. DEHYDRATION FACTORY
- 9. LABOR CAMP, WASH HOUSE, DOMESTIC
- 10. HOUSE, GARDEN, LAWN, DOMESTIC
- 11. HOUSE, GARDEN, LAWN, DOMESTIC

10 COVERED BY EXISTING RTS.

Pettus

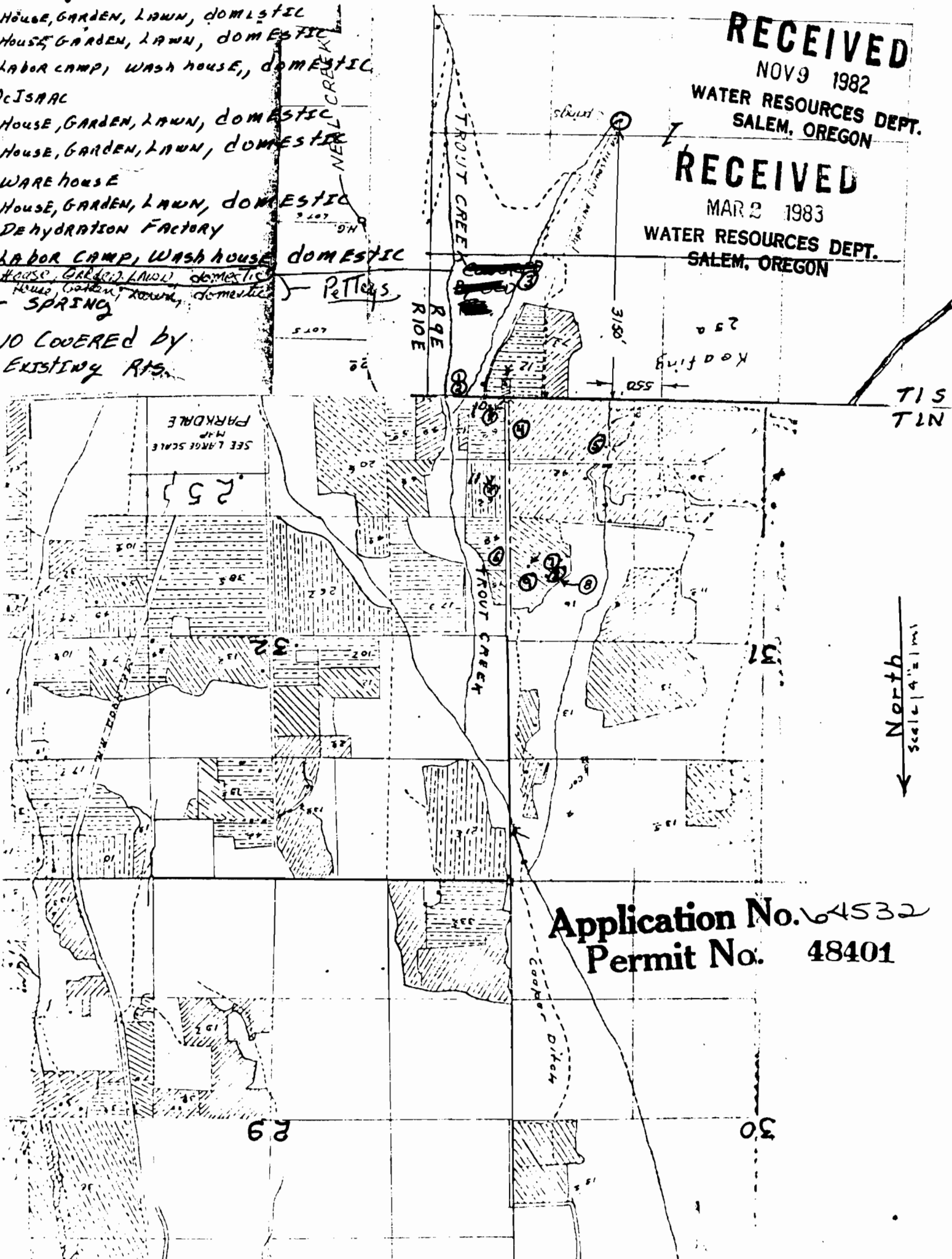

Application No. 64532
Permit No. 48401

North
Scale 1/4" = 1 mi