

E105

Township 35

Range 3 East

E105

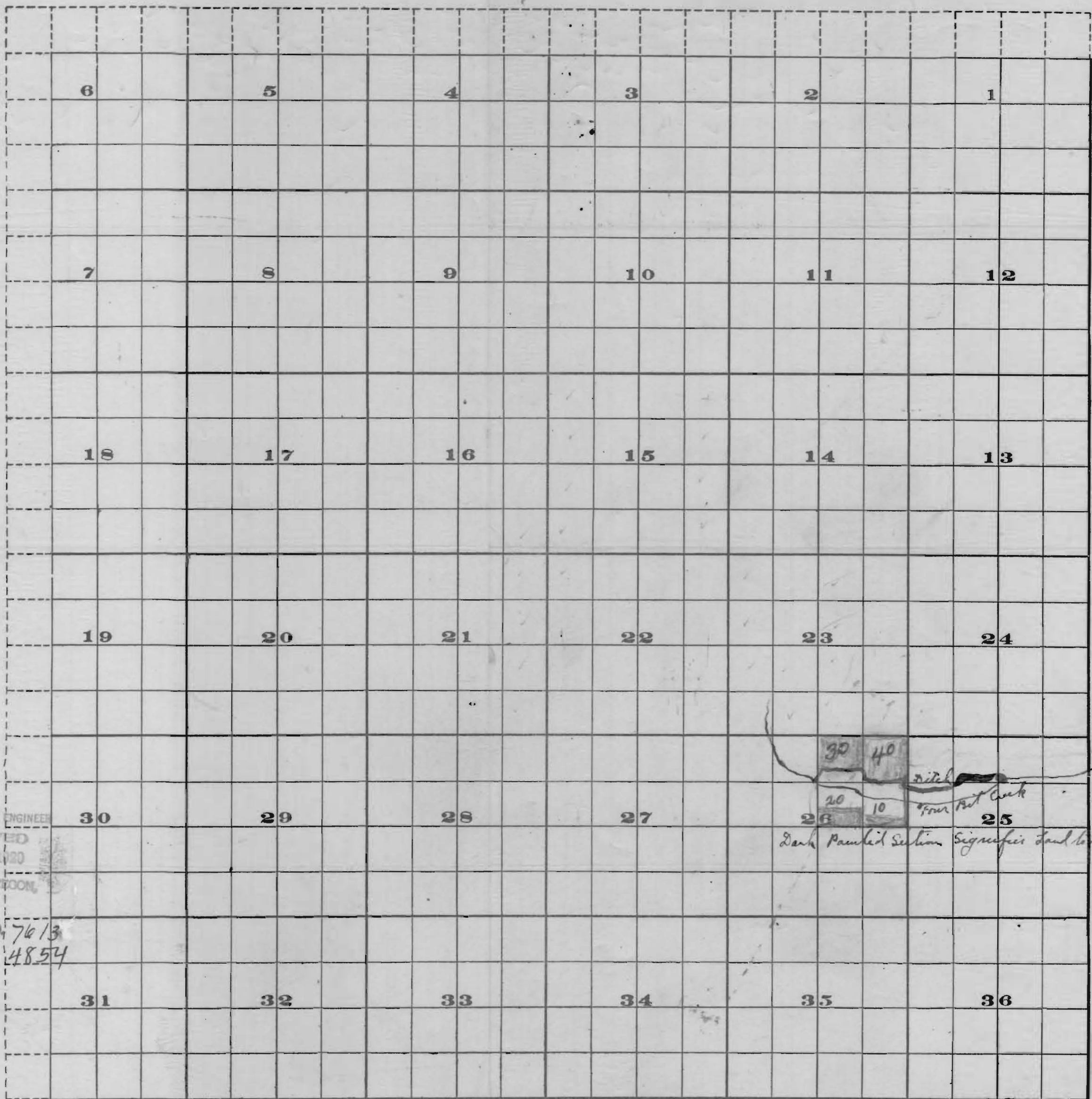

OFFICE OF STATE ENGINEER
 RECEIVED
 NOV 24 1920
 SALEM, OREGON

30 40
 20 10
 Ditch
 Four Feet Creek
 Dark Painted Section Signifies Land to be Irrigated

Application No. 7613
 Permit No. 4854

RECEIVED
 NOV 24 1920
 OFFICE OF STATE ENGINEER
 SALEM, OREGON

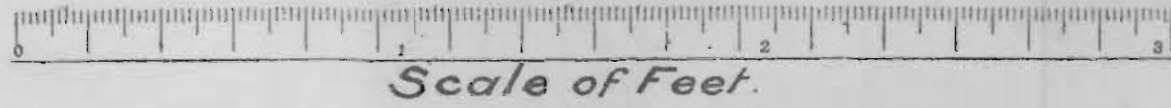

FROM OFFICE OF THE STATE ENGINEER, SALEM, OREGON

E105