

— MAP —

Accompanying application of LEVI N. STEVENS of Rogue River, Jackson County, Oregon. for permit to the waters of Evans Creek, tributary to Rogue River, Jackson County Oregon.

— March 1920. —

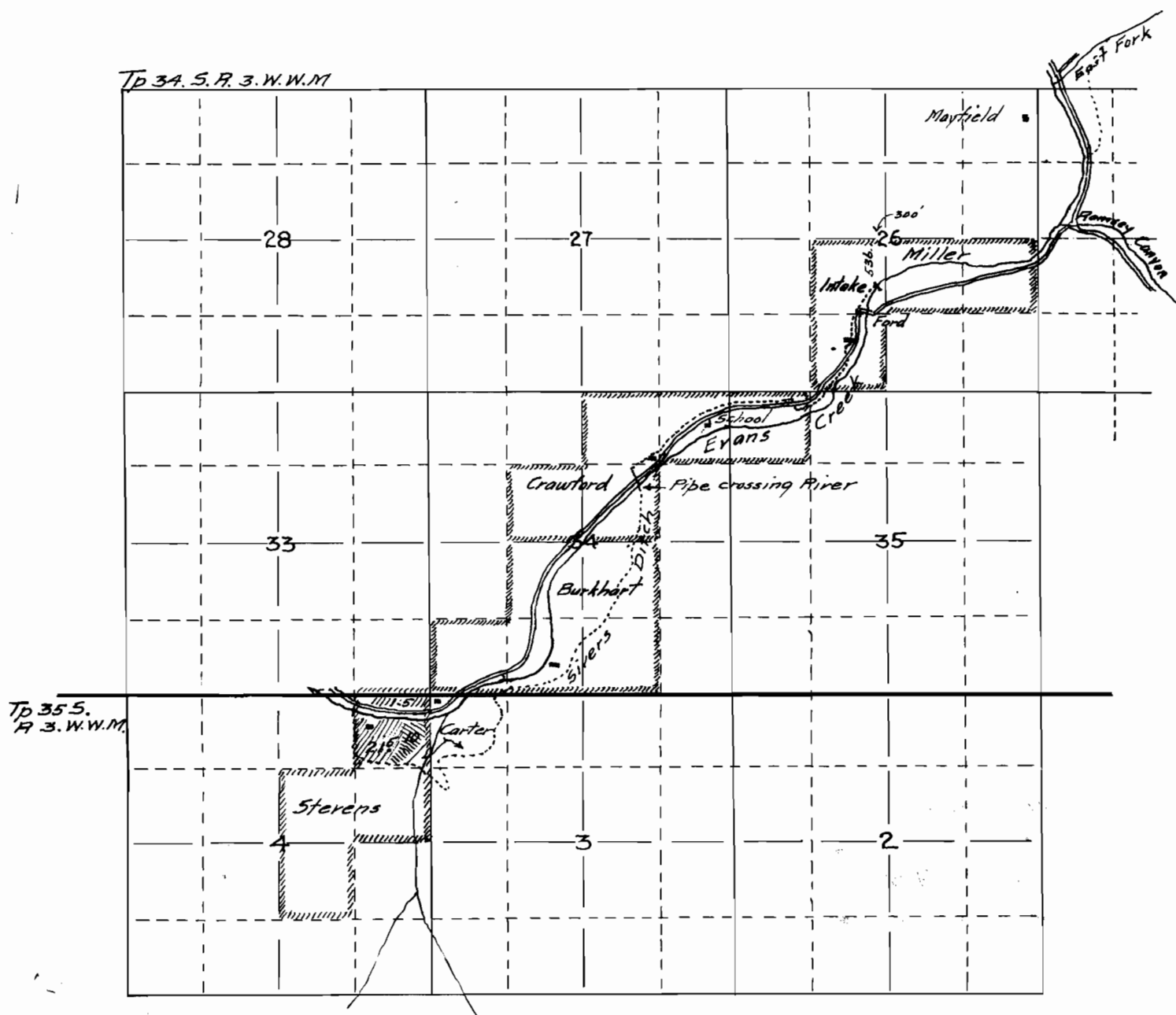

/// Prior Permit 2939. "Supplemental"

Map made from plat of lands furnished by Mr Crawford the same correctly showing the lands to be irrigated together with streams and ditches in immediate vicinity.

Compiled by

Application No. 7635 — Fred. N. Cummings. —

Permit No. 4877