

MAP

Accompanying application of RANSOM CARTER of Rogue River, Jackson County, Oregon. for permit to the waters of Evans Creek tributary to Rogue River, Jackson County Oregon.

March 1920

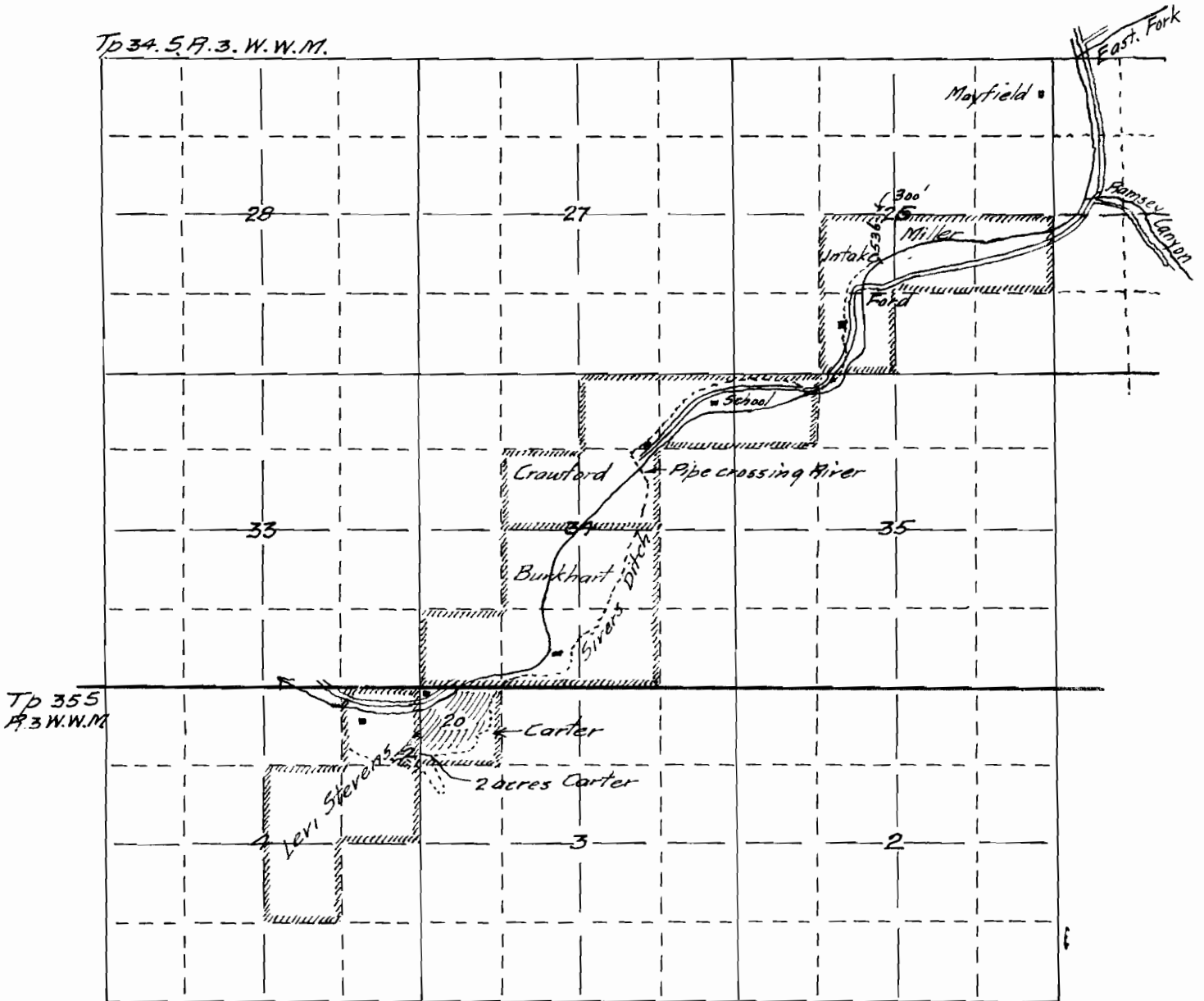

Map made from plat of lands furnished by Mr Crawford the same correctly showing the lands to be irrigated together with streams and ditches in immediate vicinity compiled by.

Fred. N. Cummings. C.E.

7670  
4920