

9 10  
16 15

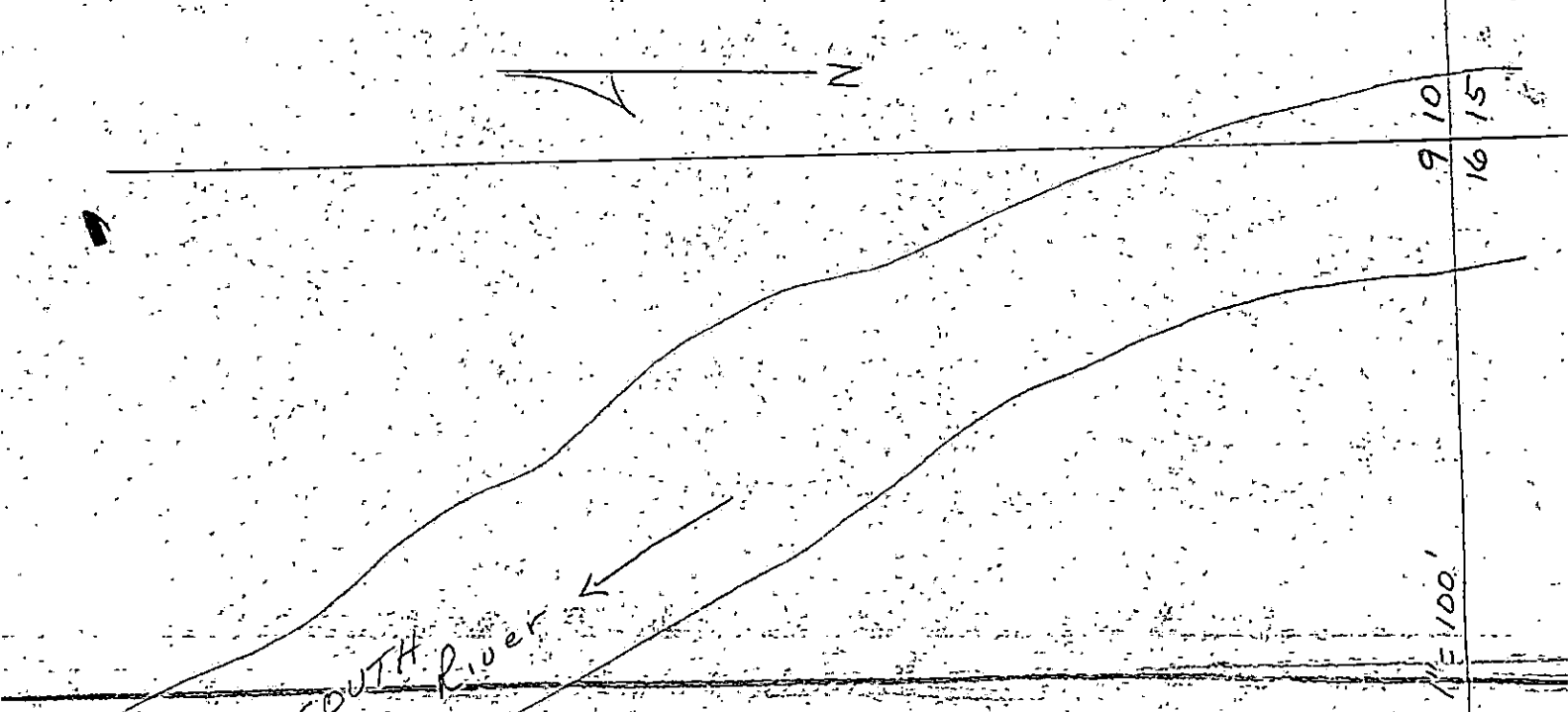

SOUTH Umpqua River

\*P.O.D.  
550' N. & 330'  
W. from SE. Cor.  
S. 9  
T.P. 305  
R. 4W

RECEIVED  
JAN 28 1965  
WATER RESOURCES DEPT  
SALEM, OREGON

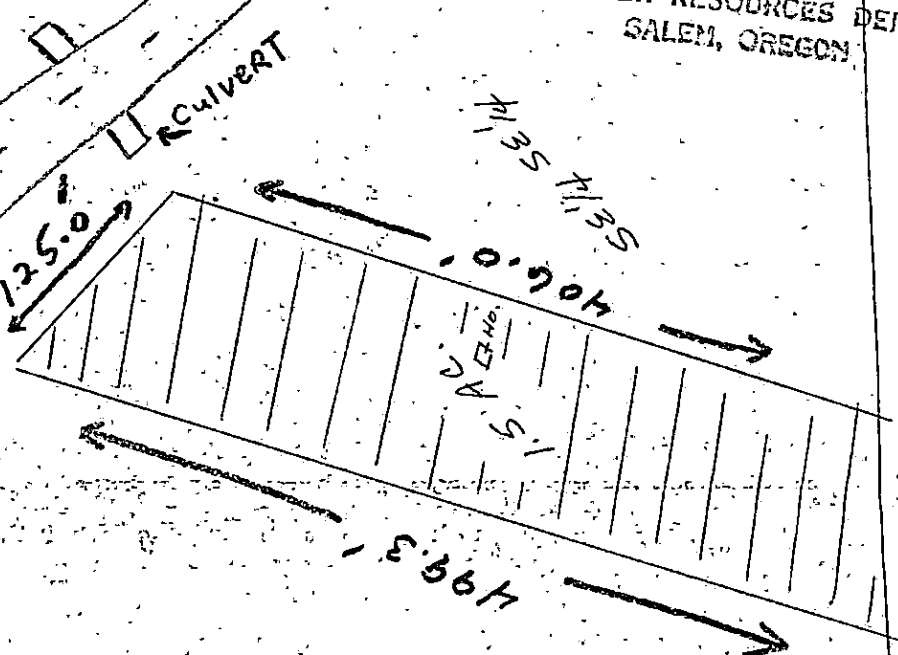

T.30S., R.4 W.

Lot Number 9  
IN Block 2  
Weaver Terrace Addition

RECEIVED  
FEB 19 1965  
WATER RESOURCES DEPT.  
SALEM, OREGON

Application No. 68259  
Permit No. 49230