

— MAP —

Accompanying application of HOWARD L. ASH of Trail
Jackson County, Oregon. for Permit to the waters of
Elk Creek tributary of Rogue River, Jackson County
Oregon. for the purpose of Irrigation.

December 1920.

Tp. 32. S. R. 1. E. W. M.

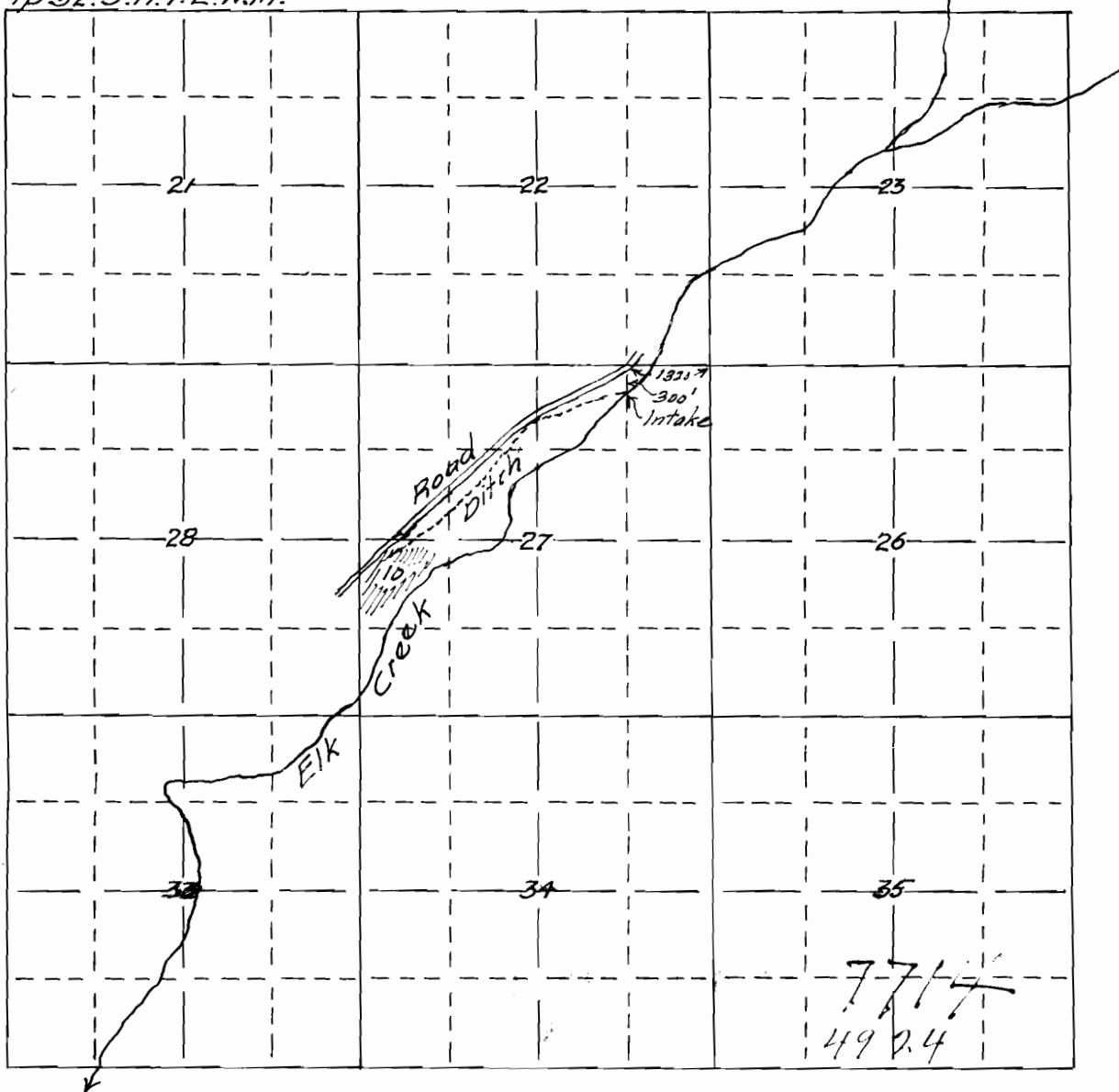

Map made from plat furnished by Mr. Ash of his
location. correctly showing lands to be irrigated
together with streams and ditches in immediate
vicinity. compiled by.

Fred. N. Cummings. C. E.