

T. 30 S. R. 5 W. W.M. RECEIVED

JUL 24 1986

WATER RESOURCES DEPT
SALEM, OREGON

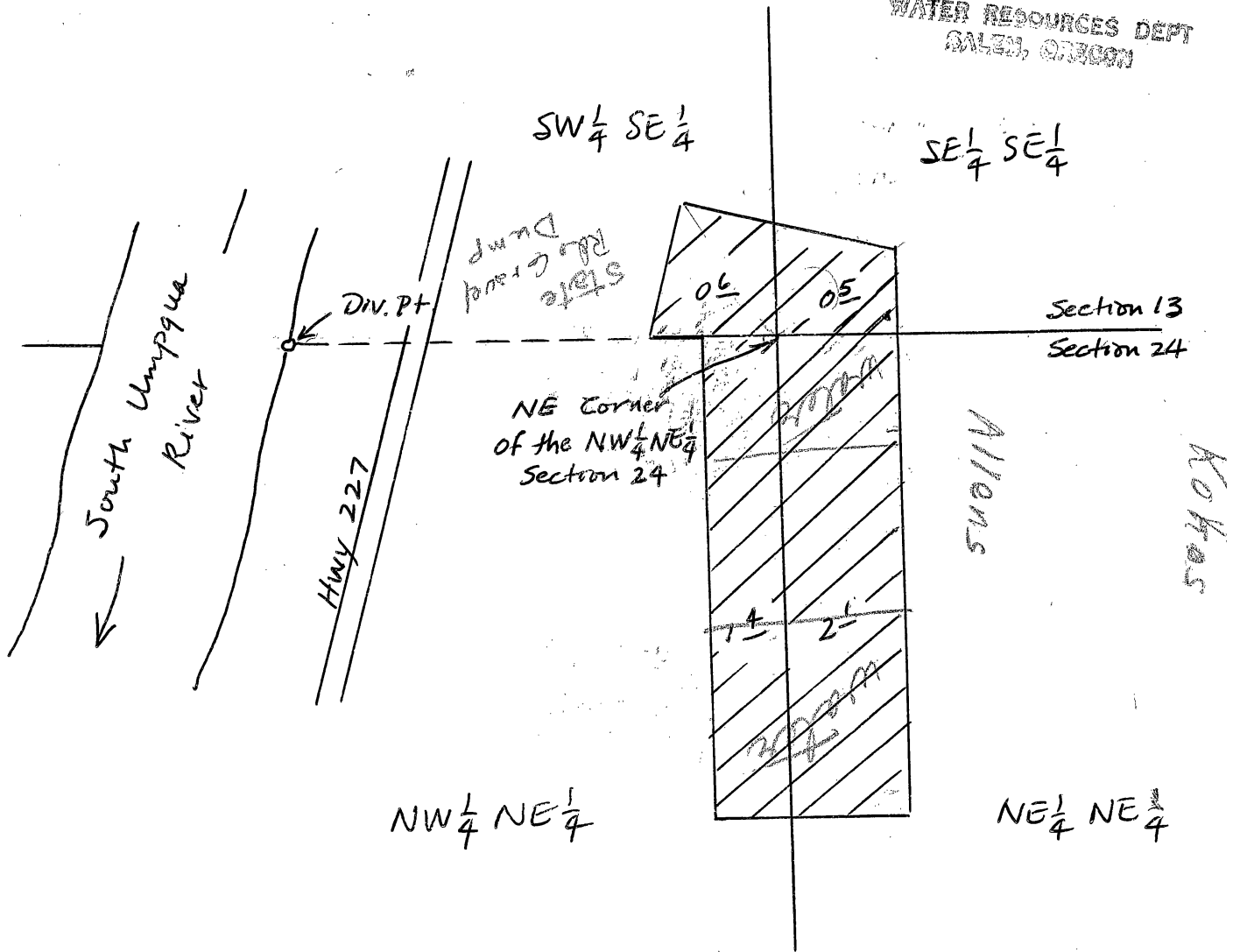

Scale: 1" = 200 ft.

Div. Pt. is 1 ft. S. and 620 ft. W. from } Descripti:
the NE Cor. NW 1/4 NE 1/4 Section 24

Application No. 68752
Permit No. 49826

RECEIVED
JUN 10 1986
WATER RESOURCES DEPT
SALEM, OREGON