

49863

37-5-19, 20

TL1901

T. 37 S., R. 5 W., W. M.

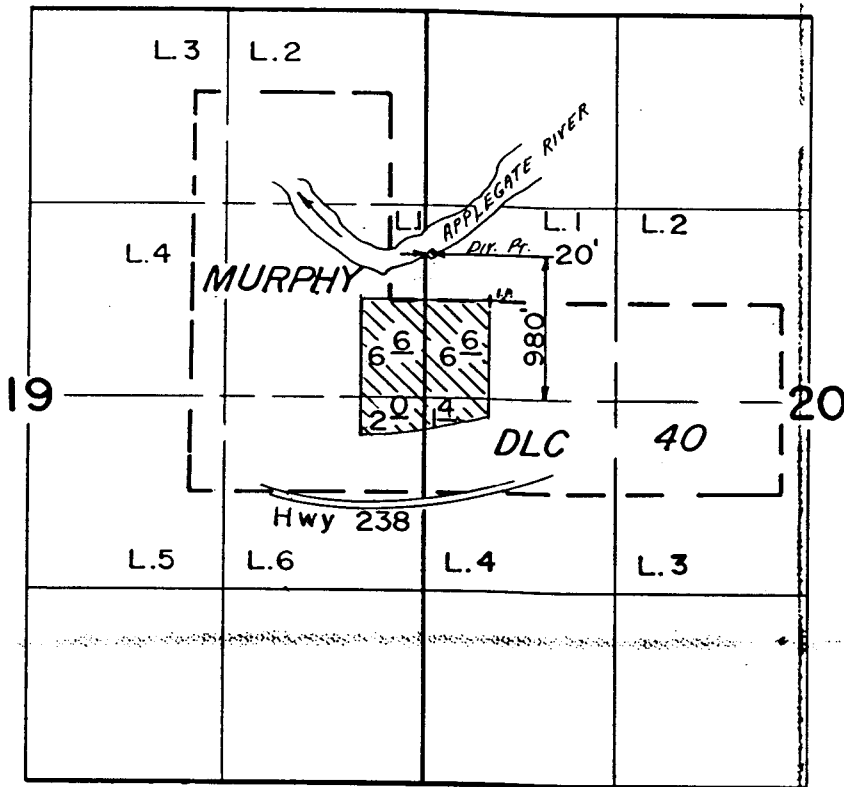

Scale: 1" = 1320'

**FINAL PROOF SURVEY**

UNDER

TRANSFER NO. 5579

Application No. 68822 Permit No. 49863

IN NAME OF

RAYMOND & CHRISTINE C. DODGE

Surveyed APR. 5, 1988, by L. M. JOACHIMS

RECEIVED

APR 15 1992

STATE OF MISSISSIPPI  
SURVEYING BOARD