

RECEIVED

MAR - 4 1987

WATER RESOURCES DEPT.
SALEM, OREGON

T. 24S., R. 29E., W.M.

BISHOP PERMIT

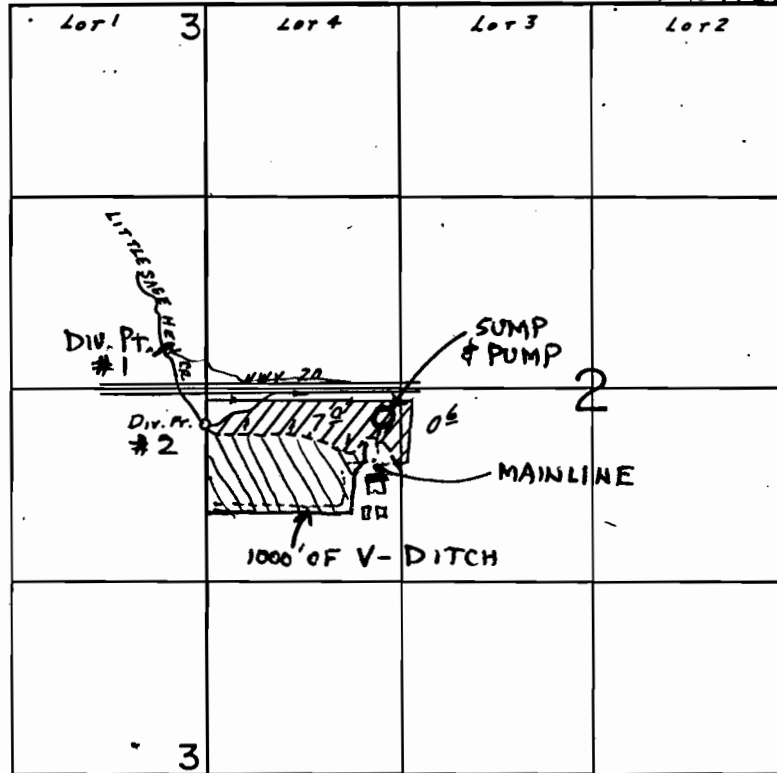

DIV. PT. LOC.: 250' S. & 10' W. FROM E. 1/4 COR. SEC. 3. -- #2
 " " " : 200' N & 225' W FROM W 1/4 COR SEC 2 -- #1
 SCALE: 1" = 1320'

KEY: — EXISTING WATER RIGHT OF 7.6 ACRES
 — PROPOSED WATER RIGHT OF APPROX. 12.4 ACRES

Application No. 68845
 Permit No. 49938