

**RECEIVED**

APR 27 1987

WATER RESOURCES DEPT  
SALEM, OREGON

Application No. 69071

Permit No. 49992

**RECEIVED**

OCT 27 2003

WATER RESOURCES DEPT  
SALEM, OREGON

T. 27 S. R. 7 W. S. 3

NE COR

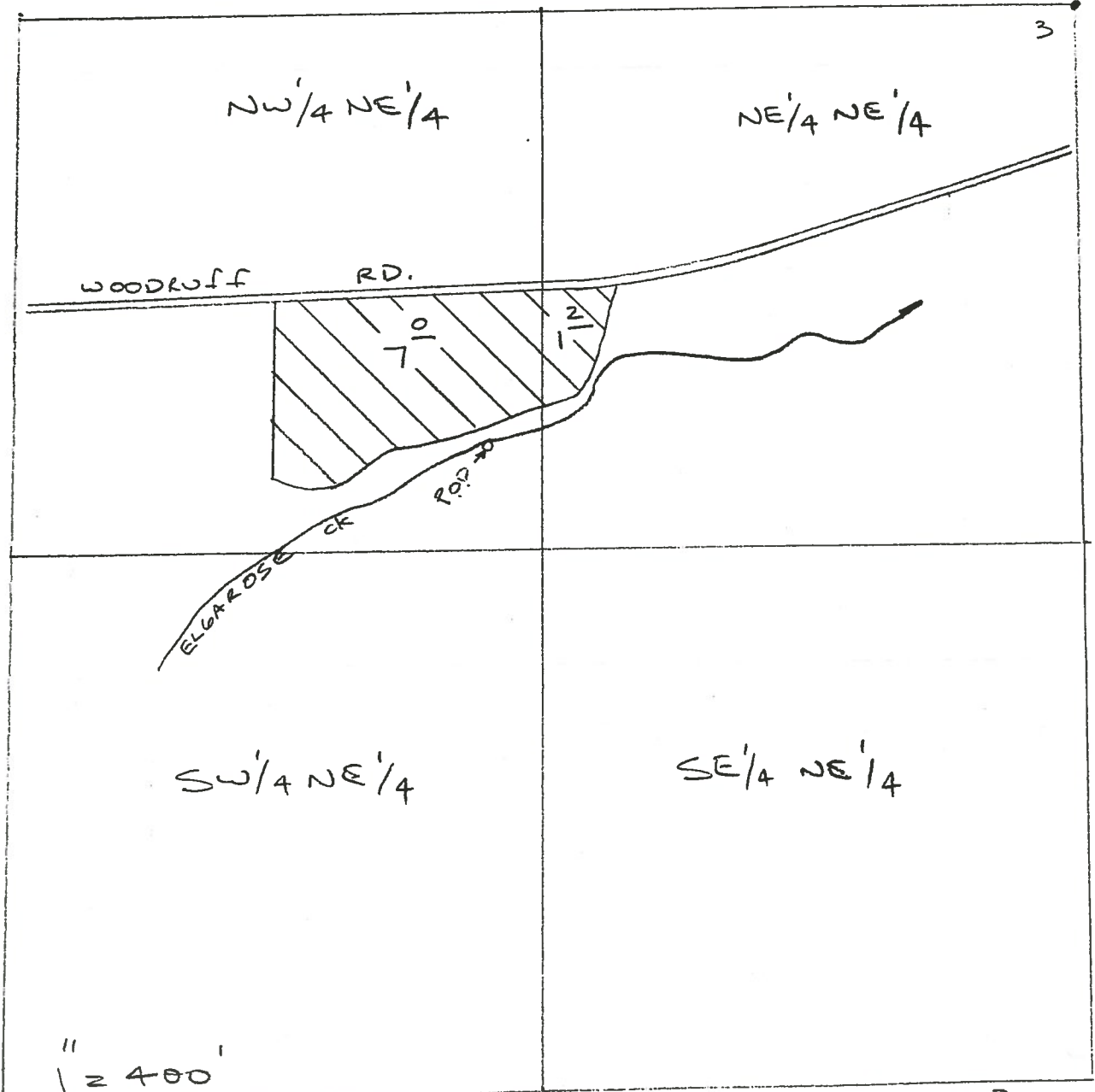

1" = 400'

PO.D = 1050' S. & 1440' W. FROM NE COR. S. 3